

369 Glue Valve

multi-application, stackable, pneumatically operated valve

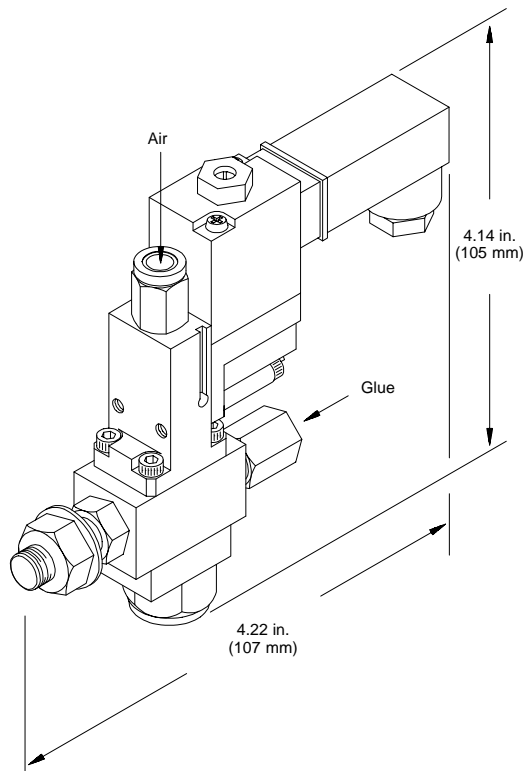

Based on Valco Cincinnati's proven 366 valve, the **369 valve** is a pneumatically operated, cold-glue valve for multiple applications. The 369 combines the features of the 366 valve with the advantages of a stackable valve. Both valves share the same internal wetted parts. The 369 valve is affordable, easy to install, and reliable, with a high cycle life.

The compact 369 valve is ideal in space-restricted areas. The total width of the valve (including solenoid valve) is only 0.8 in. (20 mm). The narrow profile permits controlled beads as close as 0.8 in. (20 mm). With the dual-orifice, contact extrusion nozzle, parallel beads of 0.4 in. (10 mm) are possible. The 369 valve can be used with slot coaters and applicator heads (block nozzles) for simultaneous, independent glue patterns.

Applications

Contact extrusion, packaging, case sealing, carton sealing, "sift-proof" gluing, laminating, bag sealing, offset web printing

Technical Data

Height	4.14 in. (105 mm)
Width	0.8 in. (20 mm)
Depth	4.22 in. (107 mm)
Operating solenoid valve	3-way valve
Max. cycle rate	3500/min
Max. fluid pressure	60 psi (4 bar)
Max. viscosity	
Contact	2000 cps
Non-contact	800 cps
Nozzle types used	408, 409, 438, 0725

369 VALVE ASSEMBLIES

Imperial (USA)	Glue fitting	Nozzle adapter	Air solenoid valve	For use with nozzle(s)
706xx034	1/8-27 NPT, female	Adapter M16 male with retainer nut (703xx942)	12 VDC, 3-way (411xx433)	408 and 409
706xx035	1/8-27 NPT, female	Block nozzle adapter (703xx945)	12 VDC, 3-way (411xx433)	0725
706xx036	1/8-27 NPT, female	438 adapter, 3/8-24, male (703xx943)	12 VDC, 3-way (411xx433)	438
706xx040	1/8-27 NPT, female	Adapter M16 male with retainer nut (703xx942)	24 VDC, 3-way (411xx429)	408 and 409
706xx041	1/8-27 NPT, female	Block nozzle adapter (703xx945)	24 VDC, 3-way (411xx429)	0725
706xx042	1/8-27 NPT, female	438 adapter, 3/8-24, male (703xx943)	24 VDC, 3-way (411xx429)	438
Metric	Glue fitting	Nozzle adapter	Air solenoid valve	For use with nozzle(s)
706xx031	1/4-19 BSPP, male	Adapter M16 male with retainer nut (703xx942)	12 VDC, 3-way (411xx433)	408 and 409
706xx032	1/4-19 BSPP, male	Block nozzle adapter (703xx945)	12 VDC, 3-way (411xx433)	0725
706xx033	1/4-19 BSPP, male	438 adapter, 3/8-24, male (703xx943)	12 VDC, 3-way (411xx433)	438
706xx037	1/4-19 BSPP, male	Adapter M16 male with retainer nut (703xx942)	24 VDC, 3-way (411xx429)	408 and 409
706xx038	1/4-19 BSPP, male	Block nozzle adapter (703xx945)	24 VDC, 3-way (411xx429)	0725
706xx039	1/4-19 BSPP, male	438 adapter, 3/8-24, male (703xx943)	24 VDC, 3-way (411xx429)	438

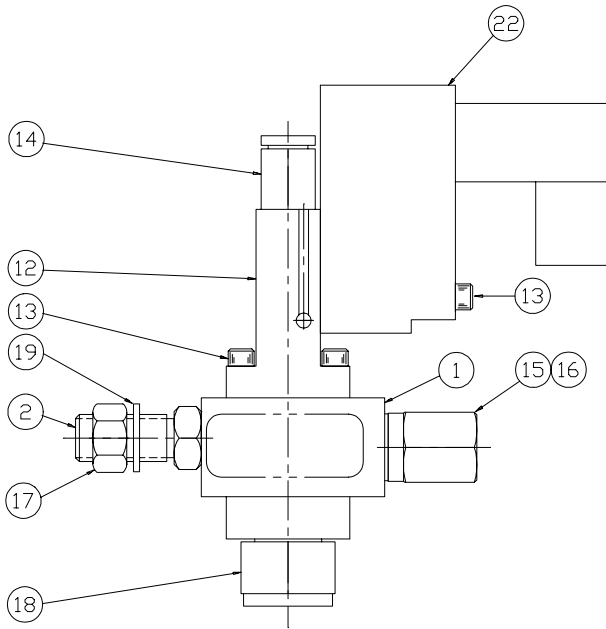

369 valve shown with
M16 nozzle adapter

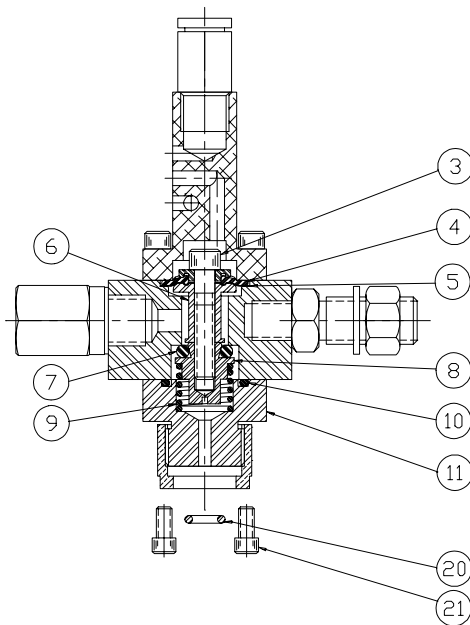

Items 20 and 21
used only with block
adapter assemblies

Replacement parts

1	Valve body	703xx944
2	Mounting stud	
	Imperial (US) version (shown)	581xx035
	Metric version	706xx206
3	Stem screw assembly	706xx177
4	Diaphragm	706xx100
5	Diaphragm protector	706xx101
6	Stem top	706xx175
7	O-ring	745xx098
8	Stem bottom	706xx176
9	Spring	706xx102
10	O-ring	745xx066
11	Nozzle adapter	
	M16 (shown)	703xx942
	Block nozzle	703xx945
	3/8-24	703xx943
12	Air manifold	753xx364
13	SHCS M3 x 30 mm	798xx180
14	Half union	
	Imperial (US) version, 1/4 tube x 1/8	797xx726
	Metric version, 6 mm tube x 1/8	797xx725
15	Copper washer	793xx470
16	Glue input connector	
	Imperial (US) version, 1/8 NPT x 1/8 BSPP	792xx135
	Metric version, 1/8 BSPP x 1/4 BSPP	792xx128
17	Hex nut	
	Imperial (US) version, 3/8-16	798xx679
	Metric version, M8	798xx362
18	Nut, M16 (incl. only with M16 adapter version)	798xx356
19	Lock washer	
	Imperial (US) version, 3/8	798xx742
	Metric version, 8 mm	798xx360
20	O-ring (only with block adapter version)	745xx381
21	SHCS (only with block adapter version)	798xx046
22	Three-way air valve	
	12 VDC	411xx433
	24 VDC	411xx429

Accessories

Type 20/20 glue manifold	999XB754-01
Glue distribution screw assembly, 1/8 BSPP	581xx014
Block nozzle 0725 for bead and ribbon patterns	999XC709-01
Blade ribbon (use with block nozzle versions)	999XB709-03
Blade bead (use with block nozzle versions)	999XB709-04
Dual-orifice glue manifolds (use with M16 adapter versions),	
Pattern width:	
0.39 in. (10 mm)	754xx353
0.59 in. (15 mm)	754xx354
0.79 in. (20 mm)	754xx355
1.18 in. (30 mm)	754xx356
Valve seal kit (366 VSK)	706xx178
Nozzles 408 and 409 (for use with M16 adapter versions)	
Nozzle 438 (for use with 3/8-24 adapter versions)	