

Fluid-Filter Maintenance

Inspecting the In-Line Fluid-Filter Screens

On new installations, the fluid-filter screens should be inspected once a week during the first month to determine maintenance requirements. After the first month, filter screens should be inspected and cleaned regularly. Service intervals should not exceed 14 days.

To remove the filter screen, follow these steps:

1. Turn the Pump off.
2. Twist off filter cap.
3. Remove filter screen.



Frequent clogging of the filter screens may indicate adhesive issues, or that the entire glue system requires cleaning.

4. Clean the filter screen.
5. Re-install the screen.
6. Rotate the 3-way valve to purge air from the filter assembly.
7. When all air has been purged from the system, rotate the valve back to the operating position.

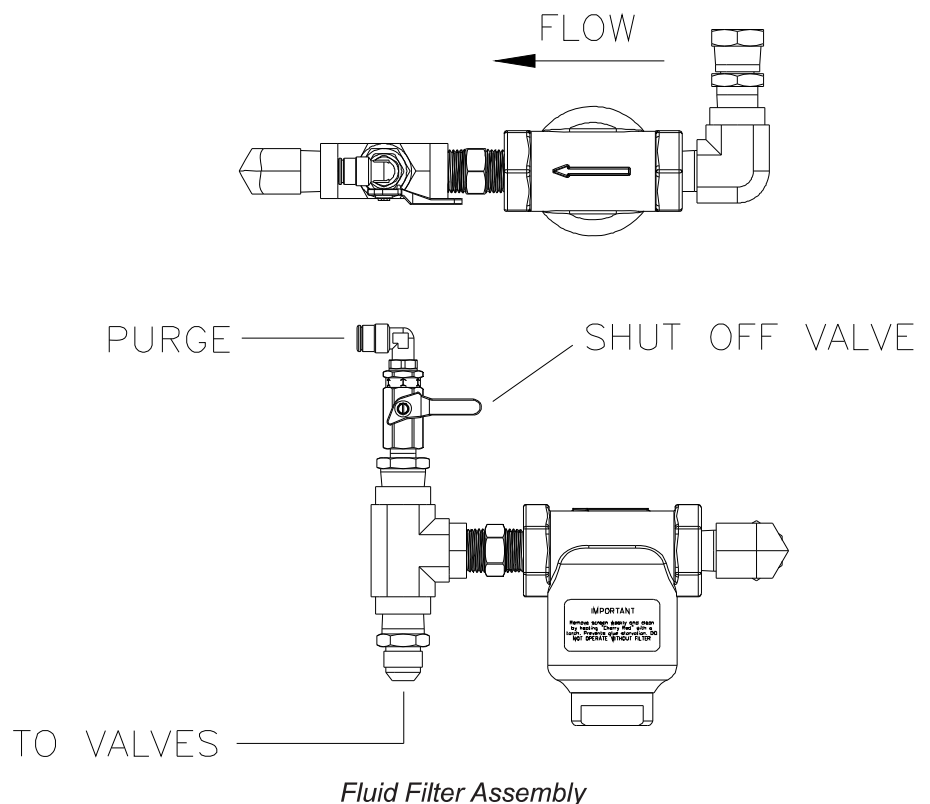

Fluid Filters

Fluid Filter assy - Part No. - 593xx299

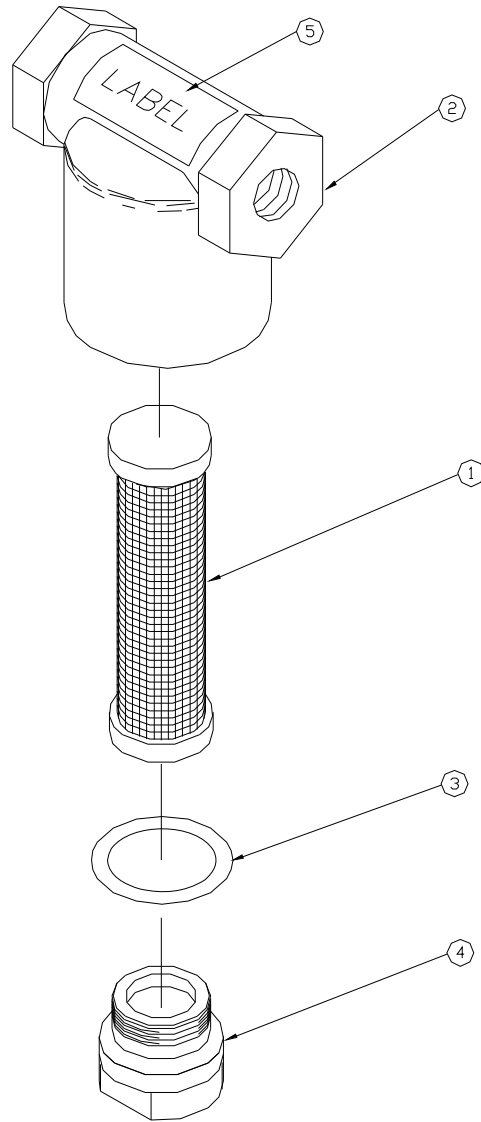

Item	Description	Part Number	Qty
1	Screen 50 mesh, SS	593XX020	1
2	Body; Fluid Filter	593XX298	1
3	O-ring	745XX059	1
4	Cap	593XX081	1
5	Label; "Important"	781XX349	1