



ValcoMelton Gluing and ClearVision Daily Maintenance

The following tasks must be carried out at the end of every shift

Gluing - must be done for both Operator Side & Drive Side gluing heads.

From inside the folding rails there is an AUTO/MANUAL Box (Picture to right) for head cleaning, turn the switch to M you will see the Valves move from the parked position to the working position as per the below picture.



When in this position using a damp cloth wipe the nozzles clean, and remove any dried adhesive, when done press the PURGE button and make sure all nozzles fire cleanly and directly down, if not keep cleaning nozzles. Coat the nozzles with Gardol release agent. **When finished make sure you switch the system back to the A position, (Valves move to Parked position)**



DEV-016
Spray
Bottle

Gardol
Release
Agent

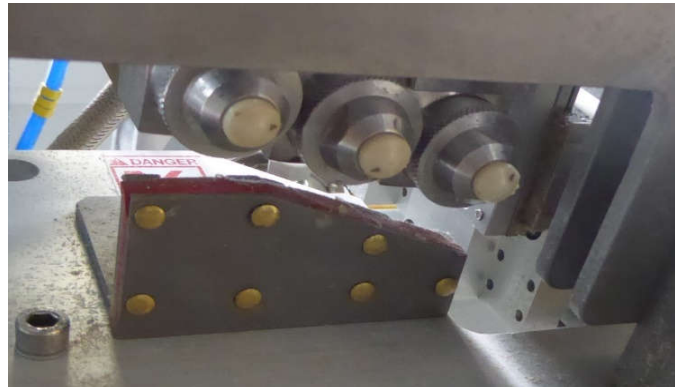

Remove any dried adhesive around the glue head assembly by spraying with Dev-016 adhesive cleaner, let soak and wipe off the adhesive.

ClearVision Daily Maintenance



GlueChek Cameras

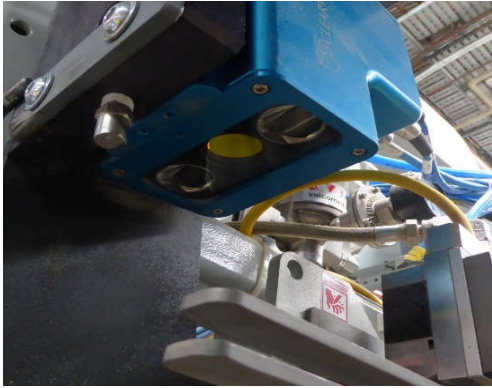

Check & Clean the Glass on both the Operator Side and Drive side GlueChek Cameras.

**3NCR Adjustment
(Reversible station)**

CAUTION!



The system must be set to 'Manual' mode when adjusting the Boardrunner.

A line on the mounting block notes the product height. Since this unit can be reversed, the product height has to be positioned correctly for top and bottom application.

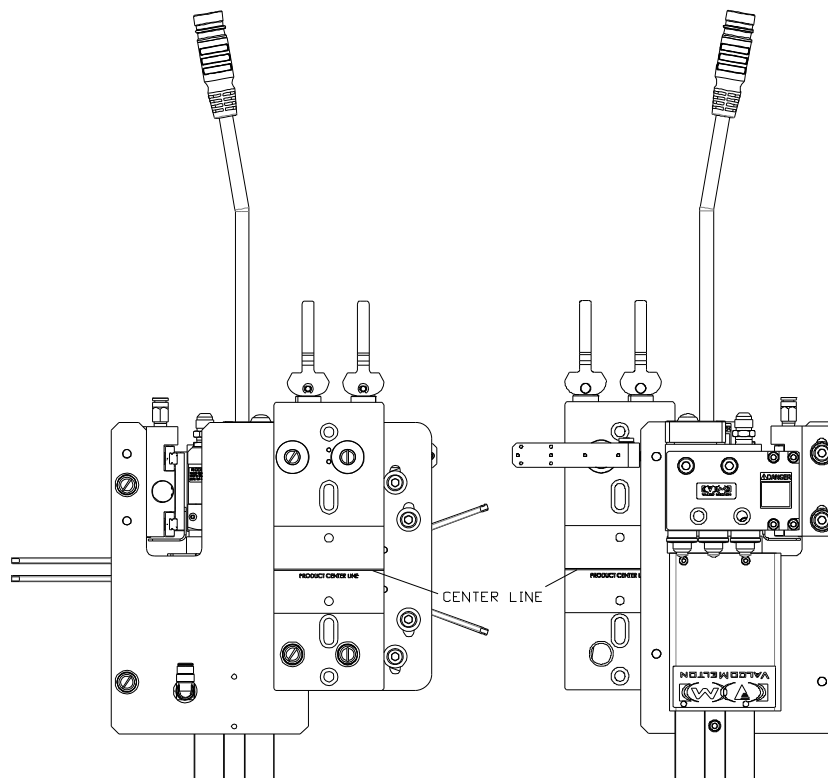

Reversing the Manifold

1. Rotate the handles down.

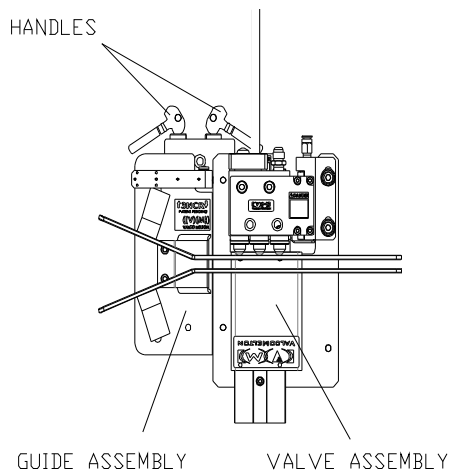

Reversing the Manifold -
Continued

2. Remove the Guide and Valve assemblies.

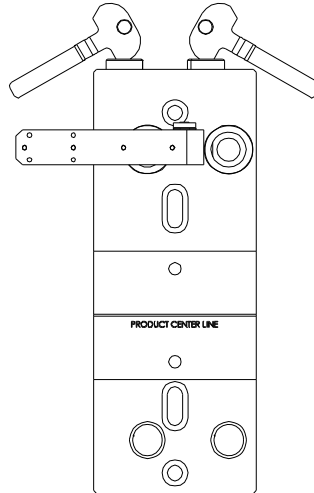

3. Reverse and re-attach the Valve Assembly.

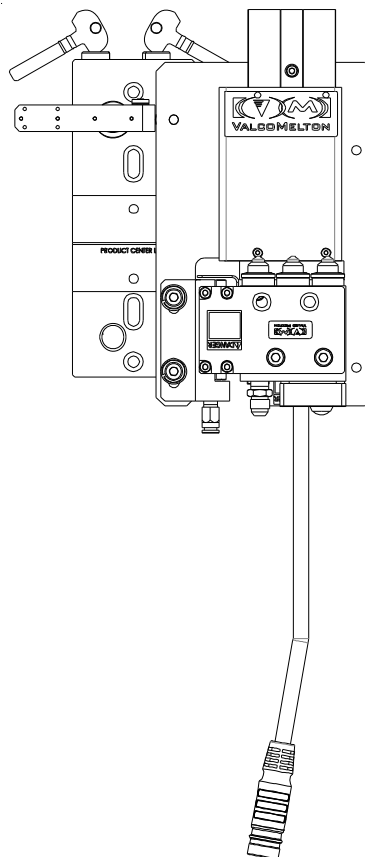

Reversing the Manifold -
Continued

4. Reattach the Guide Assembly.

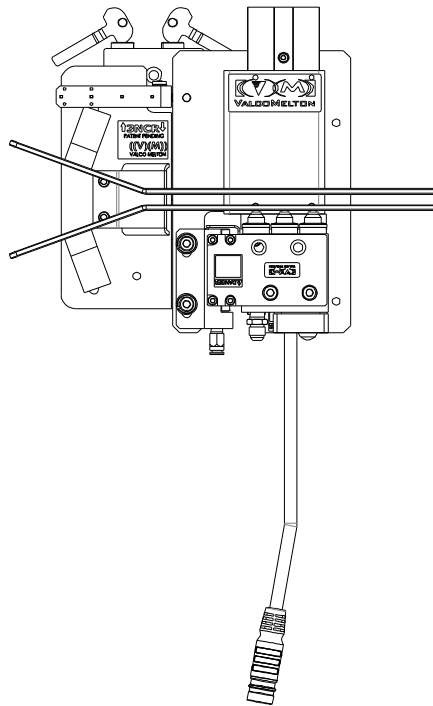

5. Rotate the handles up.

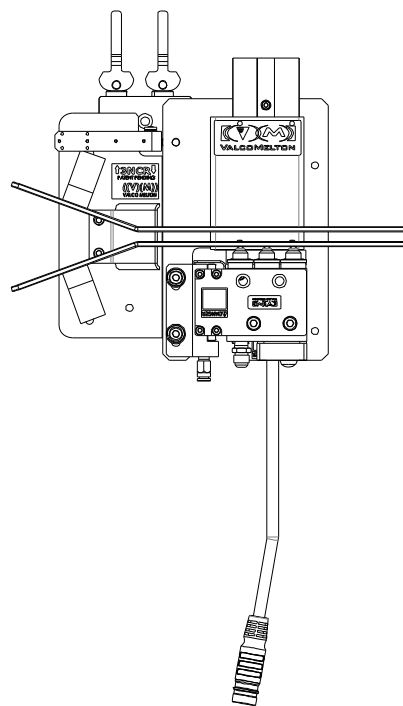

**Adjusting the Manifold
(Guides)**

1. Set the Guides as follows:
 - A. Loosen the M8 screws shown below.
 - B. Raise or lower the guides and guide mounts to the correct gap clearance. Adjust the gap to slightly greater than the thickness of the thickest product.



The box should run freely between the guides, with neither bounce nor drag.

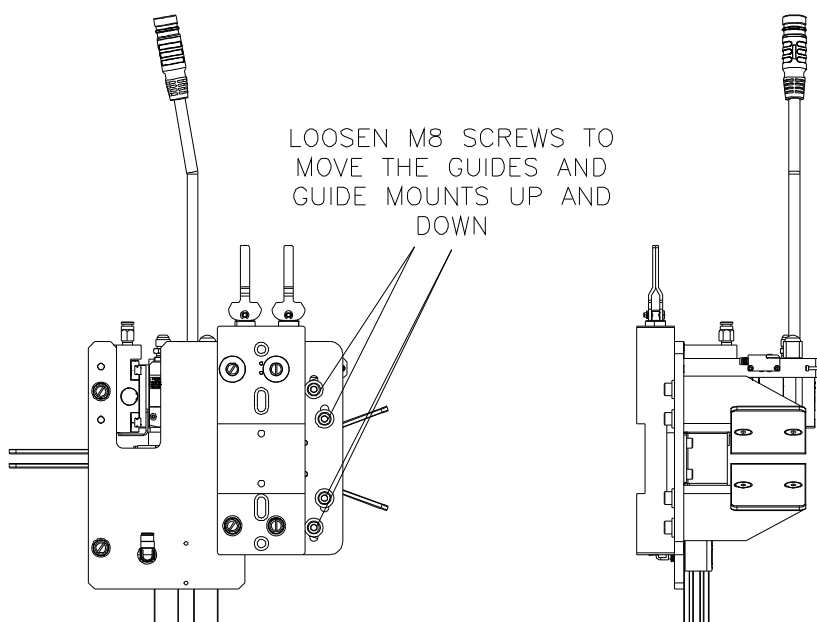

Manifold Adjustment - Reversible Station-Guides

**Adjusting the Manifold
(Valves)**

1. With the switch in Manual, set the Nozzles 3/16" (5mm) above the lower edge of the Top Guide by adjusting the manifold as follows:
 - a. Loosen the screws shown below.
 - b. Raise or lower the valves in relation to the guides.
 - c. Retighten the screws

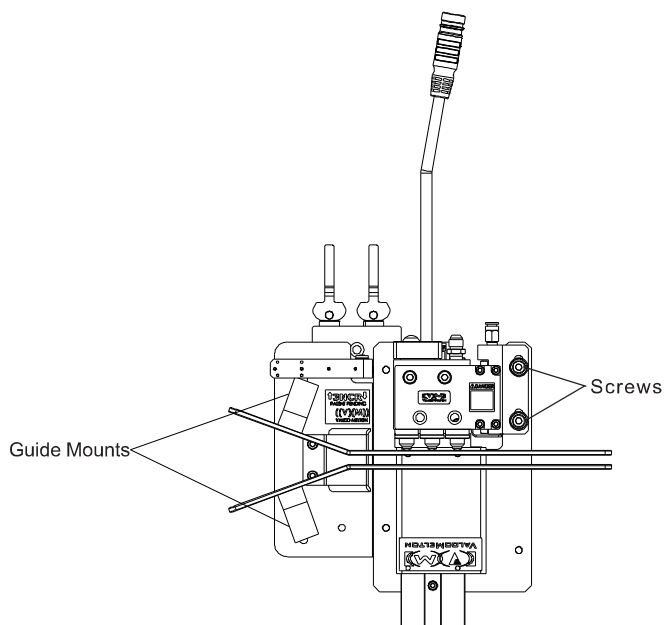

Manifold Adjustment - Reversible Station-Valves

Tipsealer Adjustment

WARNING!

Always set the Tipsealer Auto/Manual switch to “Manual” before performing any station-based adjustments. If the switch is set to auto, and the scanner were to be triggered, the glue station would move to the gluing position.

 The 3NCR Entry Level station does not include a Tipsealer.

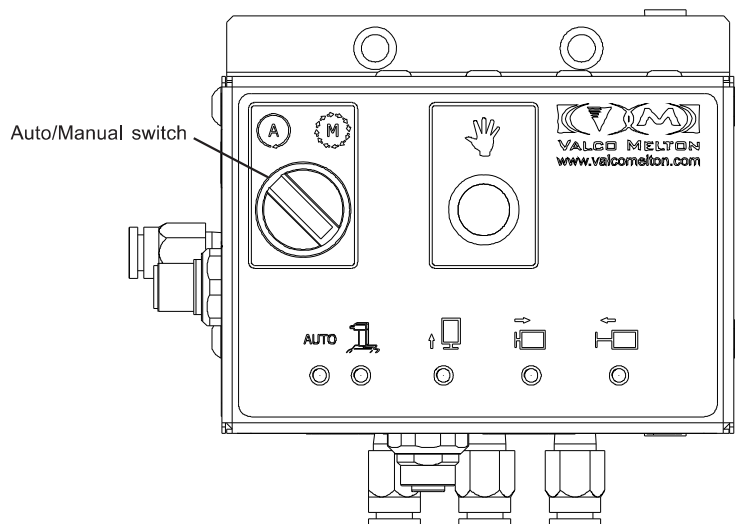

Tipsealer Auto/Manual Switch on Manifold

3NC/3NCR Tipsealer

When products stop feeding through the machine, the tipsealer manifold will move the valve manifold from the gluing position to the tip-sealing position, placing all three nozzle on the tip-sealing pad. The nozzles must be in contact with the pad to prevent the adhesive from drying on the nozzle.

If the nozzles are not all contacting the Tipsealer pad, adjust as follows:

1. Set the system to MANUAL.
2. Use a 6mm hex wrench to loosen the manifold mounting screws .
3. Adjust the manifold so the nozzles will be in contact with the Tipsealer pad.
4. Retighten the manifold mountingscrews.
5. Reset the system to AUTO. When the valves move to the Tipsealer pad, check to see if the nozzles are contacting the pad.
6. If the nozzles still do not contact the Tipsealer, repeat the above steps until the position is correct.

3NC/3NCR Tipsealer - Continued

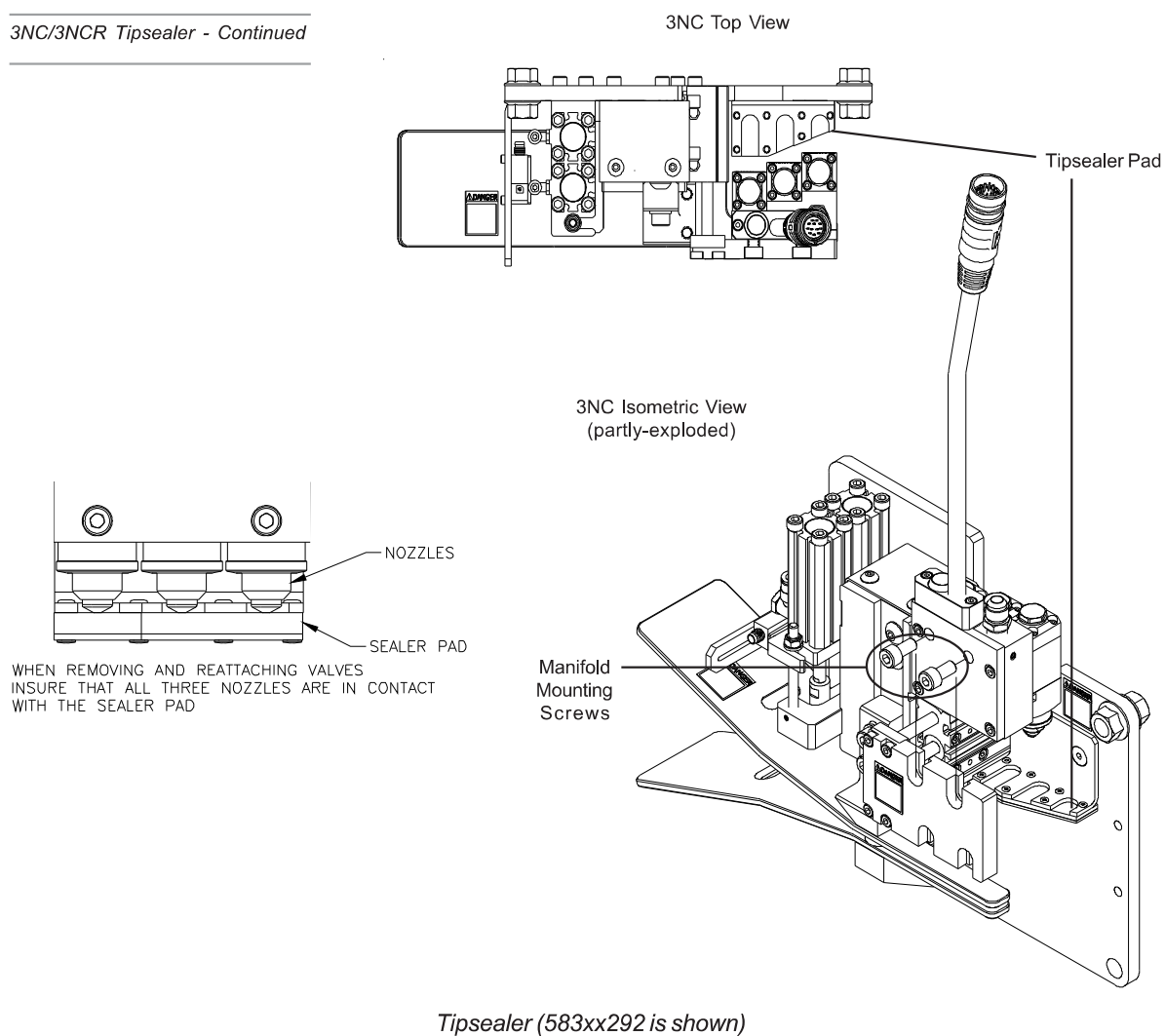

CAUTION!



The Manifold must be aligned correctly.

524 Valve Maintenance

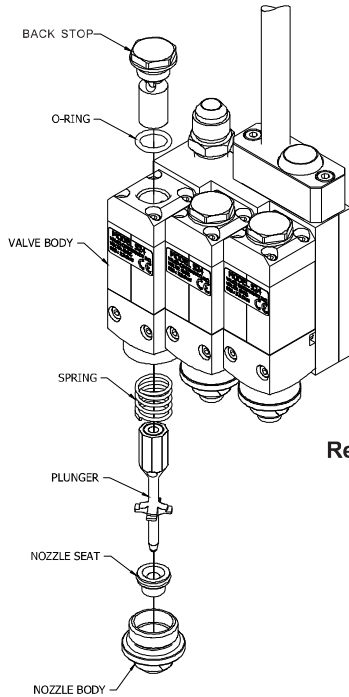

Disassembly

1. Use a 15mm wrench to loosen the Nozzle Body Assembly from the Valve Body.
2. Remove the Nozzle Body Assembly (w/Nozzle Seat), Plunger Assembly and Spring from the Valve Body



If the Nozzle Seat needs to be replaced, press it out from the lower end of the Nozzle Body. If a tool is required, take care not to damage the parts.

3. Remove the Spring from the large diameter end of the Plunger Assembly.
4. Use a 16mm wrench to loosen the Back Stop into the Valve Body.
5. Unscrew and remove the Back Stop from the Valve Body.
6. Slide the O'Ring off of the Back Stop.

Reassembly

1. Before reassembling, make sure all parts are clean and free of burrs or other debris that can cause improper operation and valve damage.
2. Slide the O'Ring over the Back Stop.
3. Thread the Back Stop into the Valve Body.
 - A. Use a 15mm wrench to tighten it completely.



If the Nozzle Seat has been removed from the Nozzle Body Assembly for replacement, insert the new Nozzle Seat into the Nozzle Body Assembly, allowing the Nozzle Seat insert to slide into the bottom of the Nozzle Body, and then use the ball end of the Plunger Assembly to gently press the Nozzle Seat into place.

4. Place the Spring over the large diameter end of the Plunger Assembly.
5. Insert the Plunger Assembly and Spring into the Valve Body.
6. Place the Nozzle Body Assembly over the ball end of the Plunger Assembly, and then thread it into the Valve Body.
 - A. Use a 15mm wrench to tighten it completely.

CAUTION!



Do not attempt to remove the valves from the manifold.
Do not soak the valve in water; use a damp cloth only.

***Cleaning the Exterior
of the Valve***

CAUTION!



Never hose or steam-clean the unit. If the surrounding area is cleaned in this manner, protect the unit by covering it with plastic or other waterproof material. OTHERWISE, EQUIPMENT DAMAGE COULD OCCUR.

Before cleaning the valve with any type of liquid, remove the solenoid. LIQUID CAN CAUSE DAMAGE TO THE SOLENOID.

The exterior of the 524 valve needs to be kept clean. To clean the exterior of the valve, follow these steps:

1. Disconnect valve from system.
2. Using a damp cloth, clean the exterior of the valve with a mild soap-and-water solution.

Reversible Glue Station, 3-Valve w/Tipsealer; Operator Side (583xx586)

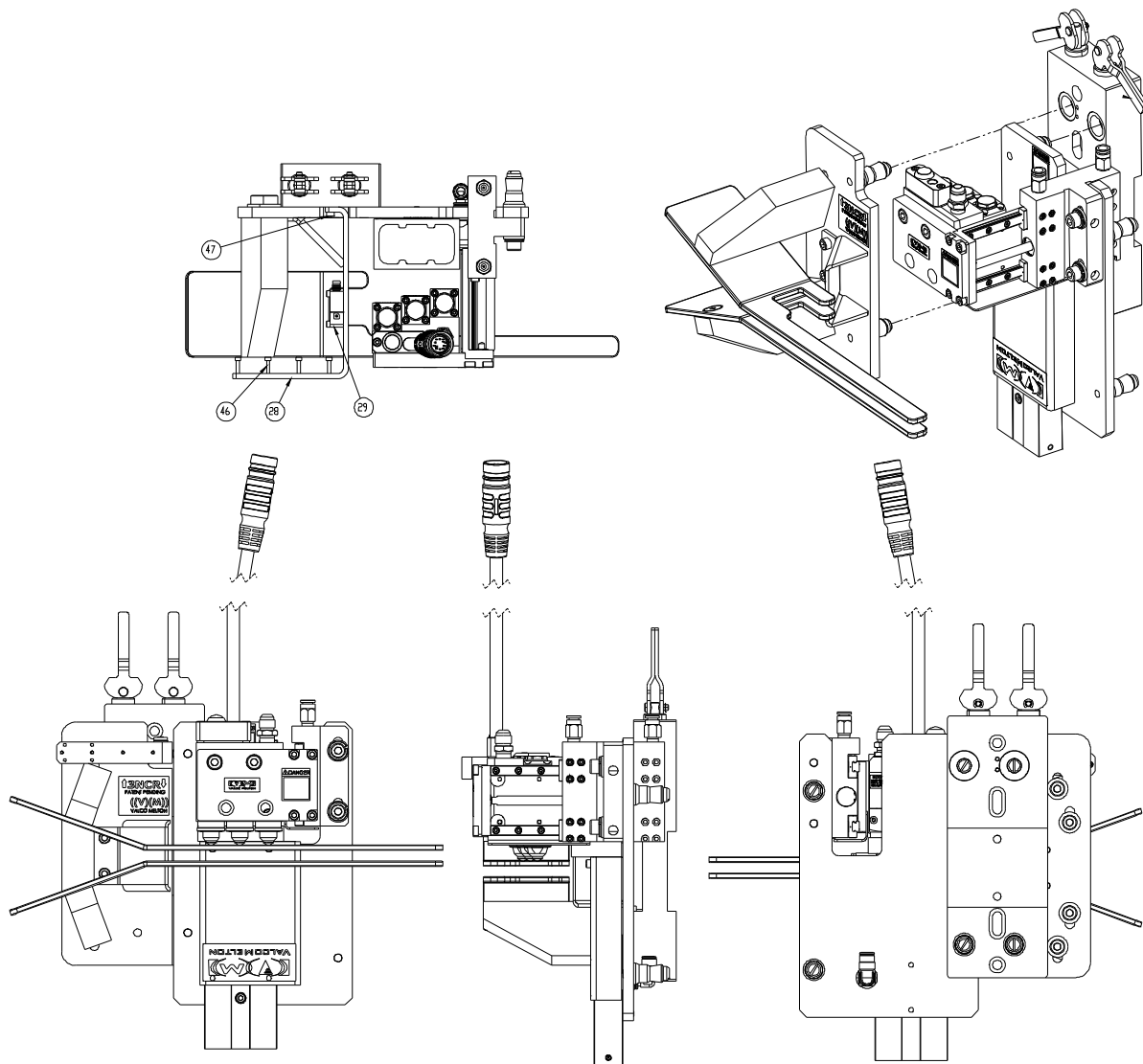

Reversible Glue Station, 3-Valve
w/Tipsealer; Operator Side
(583xx586) - Continued

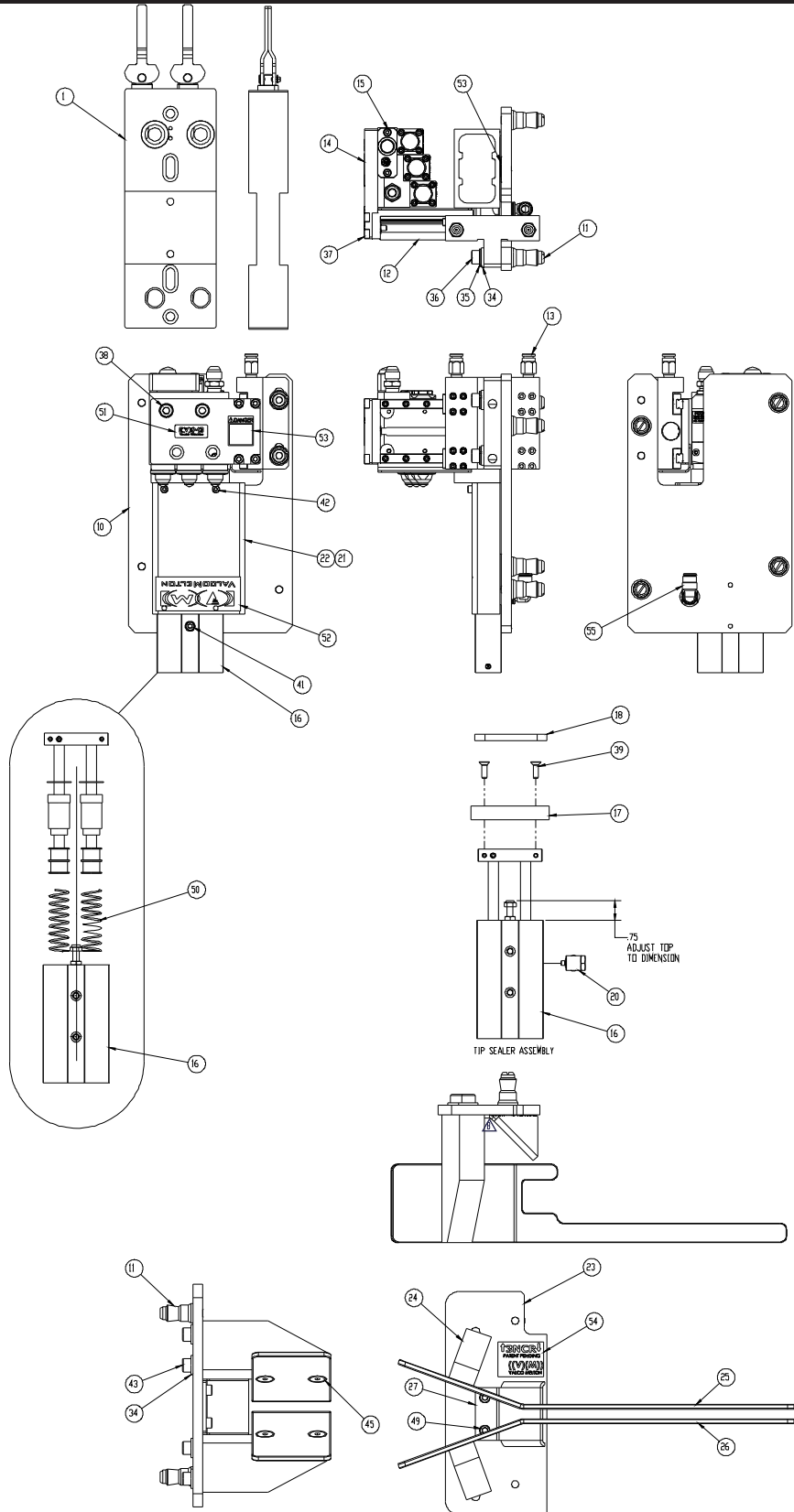

Reversible Glue Station, 3-Valve
w/Tipsealer; Operator Side
(583xx586) - Continued

| Item | Description | Part Number | Quantity |
|------|--|-------------|----------|
| 1 | BLOCK, MOUNTING; 3NCR OPERATOR SIDE | 579XX746 | 1 |
| 10 | PLATE - VALVE MOUNTING | 579XX681 | 1 |
| 11 | POST QUICK RELEASE | 579XX744 | 6 |
| 12 | AIR CYLINDER ASSY | 782XX556 | 1 |
| 13 | CONNECTOR | 799XX582 | 2 |
| 14 | PLATE - MOUNTING, FLIPABLE TRI-VALVE BR | 579XX682 | 1 |
| 15 | ASSY 3 524 VALVE MANIFOLD FOR | 583XX296 | 1 |
| 16 | CYLINDER, AIR | 782XX554 | 1 |
| 17 | CASE - TIP SEALER PAD, 3NCR | 579XX699 | 1 |
| 18 | PAD - TIP SEALER, FLIPABLE TRI-VALVE BR | 579XX698 | 1 |
| 20 | BOLT BANJO FITTING | 799XX781 | 1 |
| 21 | SPACER - CYLINDER GUARD | 579XX683 | 1 |
| 22 | GUARD - CYLINDER | 579XX684 | 1 |
| 23 | PLATE - MOUNTING GUIDES, FLIPABLE | 579XX677 | 1 |
| 24 | BLOCK - MOUNTING GUIDES | 579XX678 | 2 |
| 25 | GUIDE - PRODUCT, TOP | 579XX679 | 1 |
| 26 | GUIDE - PRODUCT, BOTTOM | 579XX680 | 1 |
| 27 | GUARD - PRODUCT | 579XX686 | 1 |
| 28 | BRACKET - SCANNER | 579XX685 | 1 |
| 29 | SENSOR ASSY | 280XX290 | 1 |
| 34 | WASHER | 784XX097 | 6 |
| 35 | WASHER | 784XX663 | 2 |
| 36 | SCREW | 784XX398 | 2 |
| 37 | SCREW | 798XX097 | 4 |
| 38 | SCREW | 884XX270 | 2 |
| 39 | SCREW | 784XX373 | 2 |
| 41 | SCREW | 798XX146 | 2 |
| 42 | SCREW | 784XX423 | 2 |
| 43 | SCREW | 784XX186 | 4 |
| 45 | SCREW | 884XX236 | 4 |
| 46 | SCREW | 798XX099 | 6 |
| 47 | SCREW | 784XX051 | 2 |
| 49 | SCREW | 798XX069 | 2 |
| 50 | SPRING | 783XX363 | 2 |
| 51 | LABEL, SMALL VALCO MELTON LOGO, 3-COLOR | 795XX614 | 1 |
| 52 | LABEL, VALCOMELTON LOGO 3-COLOR ON WHITE | 794XX917 | 1 |
| 53 | LABEL; WARNING, RED LETTERING ON WHITE | 781XX430 | 1 |
| 54 | LABEL 3NCR BOARDRUNNER | 782XX549 | 1 |
| 55 | ELBOW | 799XX817 | 1 |

Reversible Glue Station, 3-Valve w/Tipsealer; Drive Side (583xx591)

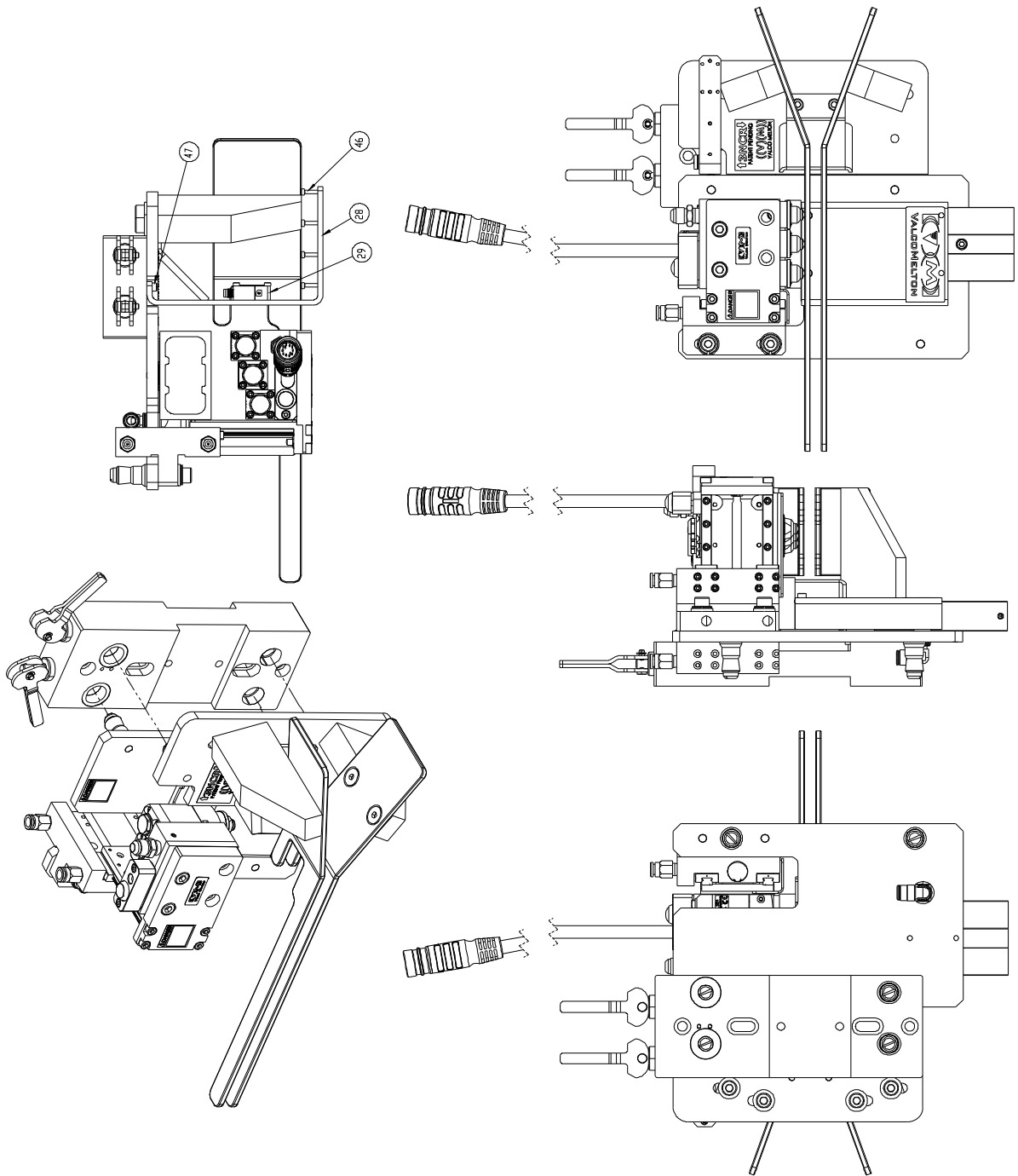

Reversible Glue Station,
3-Valve w/Tipsealer;
Drive Side (583xx591) -
Continued

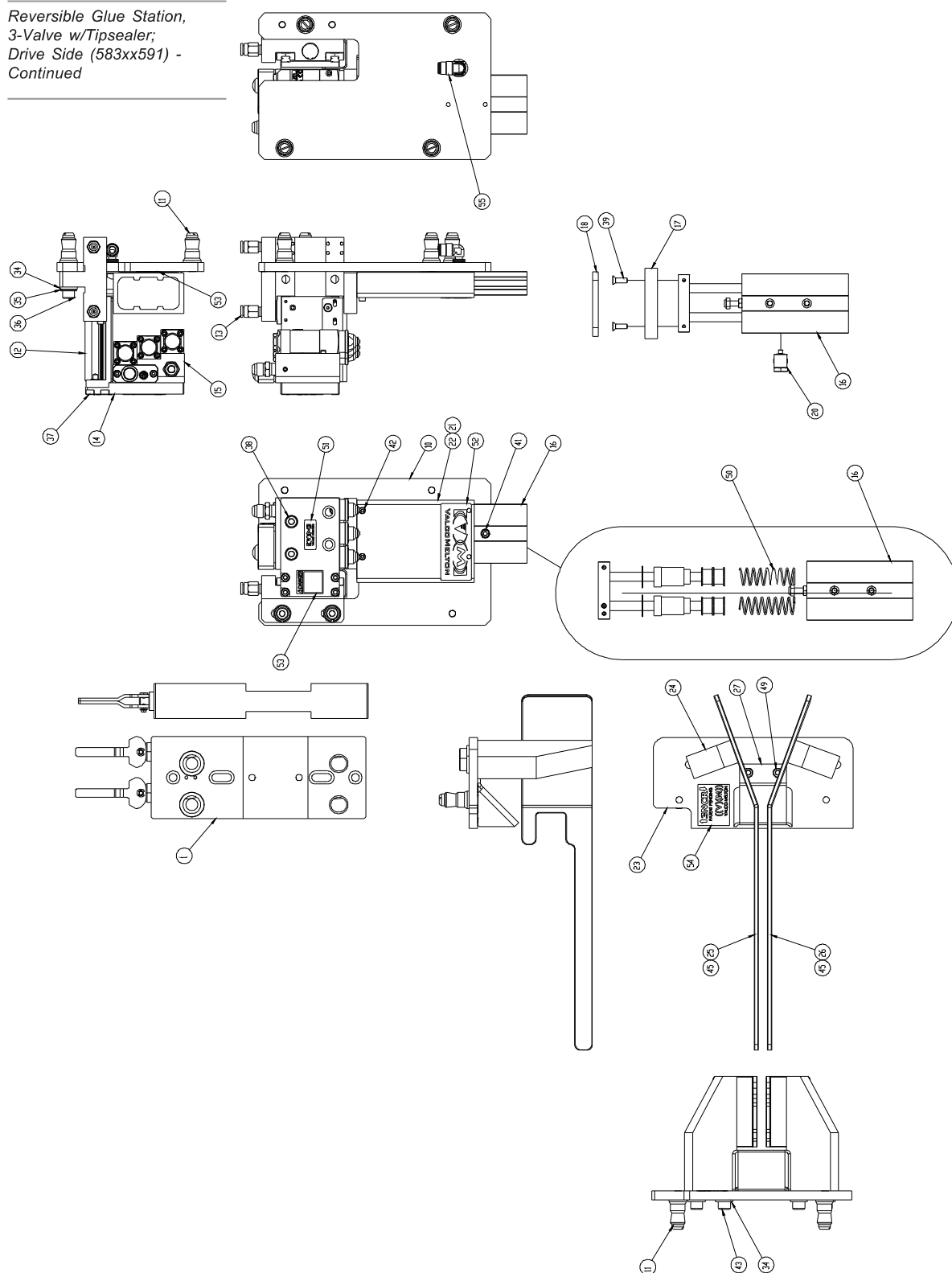

Reversible Glue Station, 3-Valve
w/Tipsealer;
Drive Side (583xx591) -
Continued

| Item | Description | Part Number | Quantity |
|------|--|-------------|----------|
| 1 | BLOCK, MOUNTING; 3NCR DRIVE SIDE | 579XX747 | 1 |
| 10 | PLATE - VALVE MOUNTING | 579XX681 | 1 |
| 11 | POST QUICK RELEASE | 579XX744 | 6 |
| 12 | AIR CYLINDER ASSY | 782XX555 | 1 |
| 13 | CONNECTOR | 799XX582 | 2 |
| 14 | PLATE - MOUNTING, FLIPABLE TRI-VALVE BR | 579XX682 | 1 |
| 15 | ASSY 3 524 VALVE MANIFOLD FOR | 583XX296 | 1 |
| 16 | CYLINDER, AIR | 782XX554 | 1 |
| 17 | CASE - TIP SEALER PAD, 3NCR | 579XX699 | 1 |
| 18 | PAD - TIP SEALER, FLIPABLE TRI-VALVE BR | 579XX698 | 1 |
| 20 | BOLT BANJO FITTING | 799XX781 | 1 |
| 21 | SPACER - CYLINDER GUARD | 579XX683 | 1 |
| 22 | GUARD - CYLINDER | 579XX684 | 1 |
| 23 | PLATE - MOUNTING GUIDES, FLIPABLE | 579XX677 | 1 |
| 24 | BLOCK - MOUNTING GUIDES | 579XX678 | 2 |
| 25 | GUIDE - PRODUCT, TOP | 579XX679 | 1 |
| 26 | GUIDE - PRODUCT, BOTTOM | 579XX680 | 1 |
| 27 | GUARD - PRODUCT | 579XX686 | 1 |
| 28 | BRACKET - SCANNER | 579XX685 | 1 |
| 29 | SENSOR ASSY | 280XX290 | 1 |
| 34 | WASHER FLAT | 784XX097 | 6 |
| 35 | WASHER LOCK | 784XX663 | 2 |
| 36 | SCREW | 784XX398 | 2 |
| 37 | SCREW | 798XX097 | 4 |
| 38 | SCREW | 884XX270 | 2 |
| 39 | SCREW | 784XX373 | 2 |
| 41 | SCREW | 798XX146 | 2 |
| 42 | SCREW | 784XX423 | 2 |
| 43 | SCREW | 784XX186 | 4 |
| 45 | SCREW | 884XX236 | 4 |
| 46 | SCREW | 798XX099 | 6 |
| 47 | SCREW | 784XX051 | 2 |
| 49 | SCREW | 798XX069 | 2 |
| 50 | SPRING | 783XX363 | 2 |
| 51 | LABEL, SMALL VALCO MELTON LOGO, 3-COLOR | 795XX614 | 1 |
| 52 | LABEL, VALCOMELTON LOGO 3-COLOR ON WHITE | 794XX917 | 1 |
| 53 | LABEL; WARNING, RED LETTERING ON WHITE | 781XX430 | 1 |
| 54 | LABEL 3NCR BOARDRUNNER | 782XX549 | 1 |
| 55 | ELBOW | 799XX817 | 1 |

| ITEM | PART NUMBER | QTY | DESCRIPTION |
|------|-------------|-----|-------------------------------------|
| 1 | 579XX746 | 1 | MOUNTING BLOCK: 3NCR: OPERATOR SIDE |
| 10 | 579XX681 | 1 | PLATE - MOUNTING |
| 11 | 579XX744 | 6 | QUICK RELEASE POST |
| 12 | 782XX556 | 1 | AIR CYLINDER ASSY |
| 13 | 799XX582 | 2 | FITTING: 8mm TUBE X 1/8 NPT |
| 14 | 579XX682 | 1 | MOUNTING PLATE - VALVE |
| 15 | 583XX296 | 1 | VALVE CARTRIDGE |
| 16 | 782XX696 | 1 | AIR CYLINDER ASSY: OPERATOR SIDE |
| 17 | 579XX699 | 1 | CASE - TIP SEALER PAD |
| 18 | 579XX698 | 1 | PAD |
| 20 | 799XX781 | 1 | BANJO FITTING: M5 X 8mm |
| 21 | 579XX683 | 1 | SPACER - COVER |
| 22 | 579XX684 | 1 | COVER, CYLINDER |
| 23 | 579XX677 | 1 | PLATE - MOUNTING |
| 24 | 579XX854 | 2 | GUIDE MOUNT |
| 25 | 579XX855 | 2 | PRODUCT GUIDE |
| 27 | 579XX686 | 1 | GUARD, PRODUCT |
| 28 | 579XX685 | 1 | BRACKET - SCANNER |
| 29 | 280XX290 | 1 | WENGLER SCANNER ASSY |
| 34 | 784XX097 | 6 | WASHER M8 NARROW SS |
| 35 | 784XX663 | 2 | WASHER SPLIT LOCK M8 SS |
| 36 | 784XX398 | 2 | SHCS M8 X 25 SS |
| 37 | 798XX097 | 4 | SHCS M5 X 10 S.S. |
| 38 | 884XX270 | 2 | SHCS M8 X 16 SS |
| 39 | 784XX373 | 2 | FHMS M5 X 16 BO |
| 41 | 798XX146 | 2 | SHCS M5 X 30 SS |
| 42 | 784XX423 | 2 | SHCS M4 X 10 SS |
| 43 | 784XX186 | 4 | SHCS M8 X 30 SS |
| 46 | 798XX099 | 6 | SHCS M3 X 16 SS |
| 47 | 784XX051 | 2 | SHCS M4 X 12 SS |
| 49 | 798XX049 | 2 | SHCS M6 X 12 SS |
| 51 | 795XX614 | 1 | LABEL |
| 52 | 794XX917 | 1 | LABEL VALCO MELTON LOGO |
| 53 | 781XX430 | 1 | WARNING LABEL |
| 54 | 782XX549 | 1 | LABEL "3NCR" |
| 55 | 799XX817 | 1 | ELBOW 8mm POST X 8mm PUSH |
| 57 | 784XX091 | 2 | SHCS M6 X 16 SS |
| 58 | 798XX753 | 6 | PLAIN WASHER M3 |

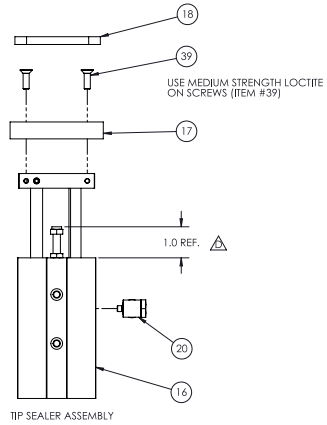
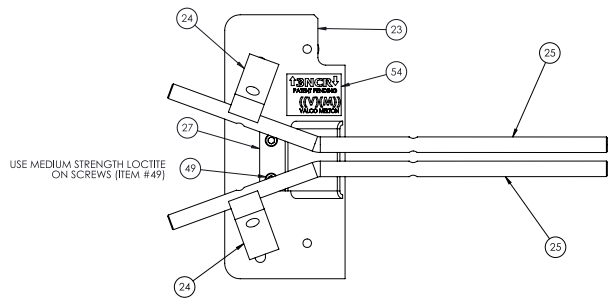
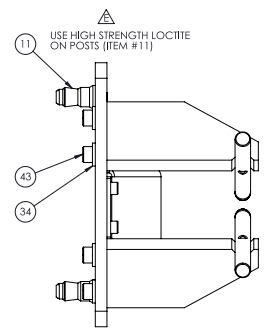
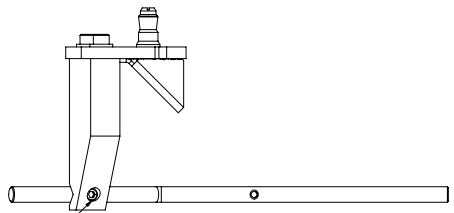
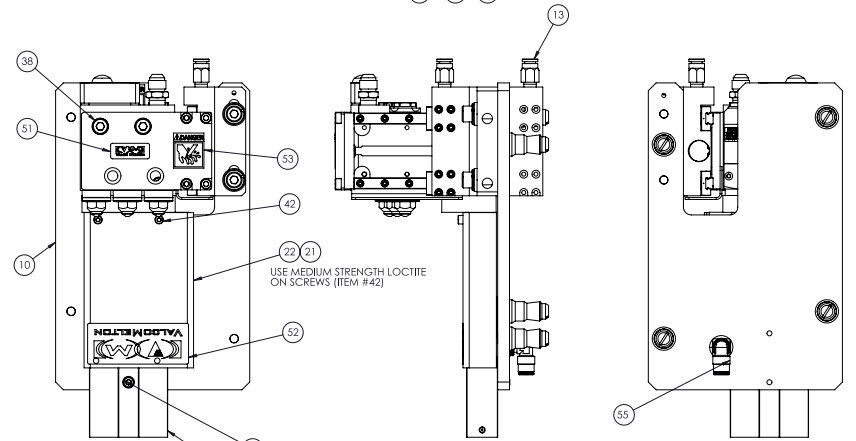
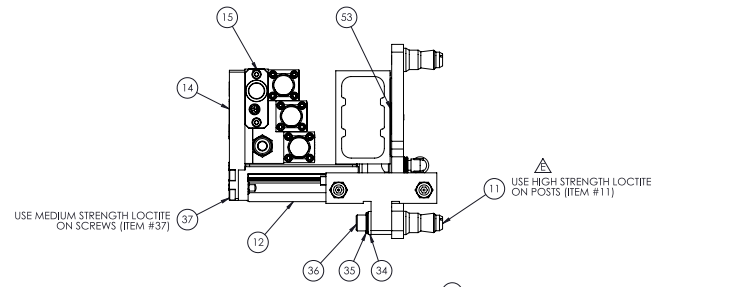
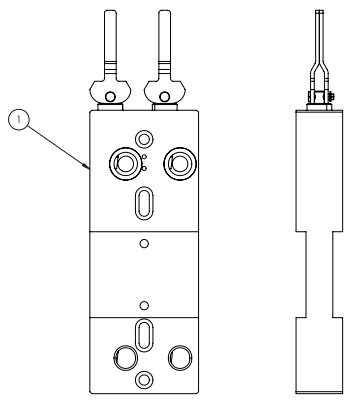

| REV | CONT. | DATE | BY | CHKD | APP'D | DESCRIPTION |
|-----|---------|---------|--------|------|-------|---|
| 1 | REVISED | 15JAN14 | S.M.T. | | | ASSEMBLY - FLIPABLE BOARDRUNNER TRIP-VALVE W/TIP SEALER OPERATOR SIDE |
| 2 | REVISED | 15JAN14 | S.M.T. | | | 583XX586-01 |

| ITEM | PART NUMBER | QTY | DESCRIPTION |
|------|-------------|-----|-------------------------------------|
| 1 | 579XX746 | 1 | MOUNTING BLOCK; 3NCR; OPERATOR SIDE |
| 10 | 579XX681 | 1 | PLATE - MOUNTING |
| 11 | 579XX744 | 6 | QUICK RELEASE POST |
| 12 | 782XX556 | 1 | AIR CYLINDER ASSY |
| 13 | 799XX582 | 2 | FITTING; 8mm TUBE X 1/8 NPT |
| 14 | 579XX682 | 1 | MOUNTING PLATE - VALVE |
| 15 | 583XX296 | 1 | VALVE CARTRIDGE |
| 16 | 782XX696 | 1 | AIR CYLINDER ASSY; OPERATOR SIDE |
| 17 | 579XX699 | 1 | CASE - TIP SEALER PAD |
| 18 | 579XX698 | 1 | PAD |
| 20 | 799XX781 | 1 | BANJO FITTING; M5 X 8mm |
| 21 | 579XX683 | 1 | SPACER - COVER |
| 22 | 579XX684 | 1 | COVER, CYLINDER |
| 23 | 579XX677 | 1 | PLATE - MOUNTING |
| 24 | 579XX854 | 2 | GUIDE MOUNT |
| 25 | 579XX855 | 2 | PRODUCT GUIDE |
| 27 | 579XX686 | 1 | GUARD, PRODUCT |
| 28 | 579XX685 | 1 | BRACKET - SCANNER |
| 29 | 280XX290 | 1 | WENGLER SCANNER ASSY |
| 34 | 784XX097 | 6 | WASHER M8 NARROW SS |
| 35 | 784XX643 | 2 | WASHER SPLIT LOCK M8 SS |
| 36 | 784XX398 | 2 | SHCS M8 X 25 SS |
| 37 | 798XX097 | 4 | SHCS M5 X 10 S.S. |
| 38 | 884XX270 | 2 | SHCS M8 X 16 SS |
| 39 | 784XX373 | 2 | FHMS M5 X 16 SS |
| 41 | 798XX146 | 2 | SHCS M5 X 30 SS |
| 42 | 784XX423 | 2 | SHCS M4 X 10 SS |
| 43 | 784XX186 | 4 | SHCS M8 X 30 SS |
| 46 | 798XX099 | 6 | SHCS M3 X 16 SS |
| 47 | 784XX051 | 2 | SHCS M4 X 12 SS |
| 49 | 798XX069 | 2 | SHCS M6 X 12 SS |
| 51 | 795XX614 | 1 | LABEL |
| 52 | 794XX917 | 1 | LABEL, VALCO MELTON LOGO |
| 53 | 781XX430 | 1 | WARNING LABEL |
| 54 | 782XX549 | 1 | LABEL "3NCR" |
| 55 | 799XX817 | 1 | ELBOW 8mm POST X 8mm PUSH |
| 57 | 784XX091 | 2 | SHCS M6 X 16 SS |
| 58 | 798XX753 | 6 | PLAIN WASHER M3 |

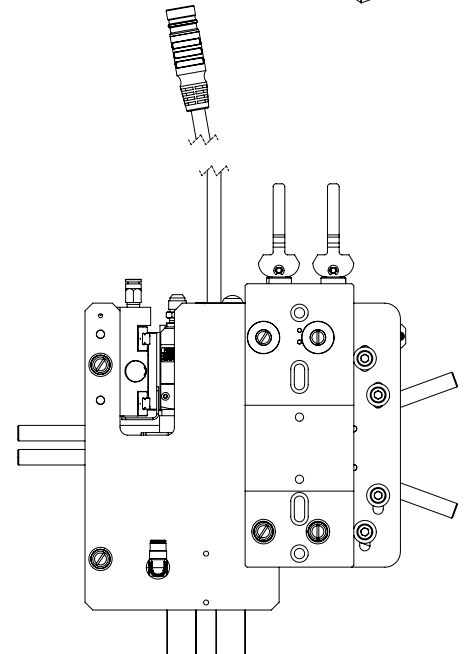
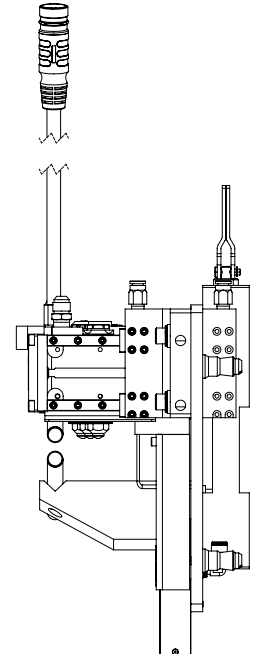
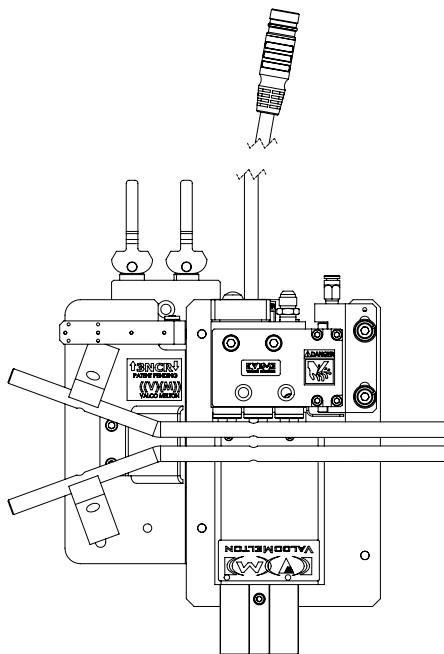
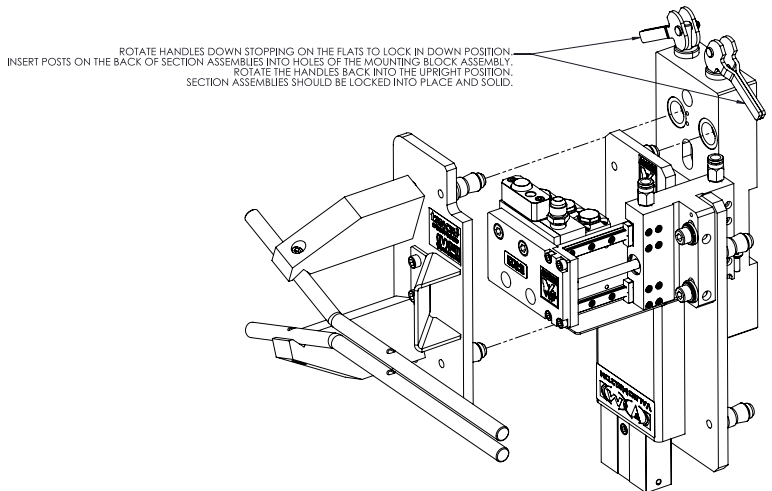
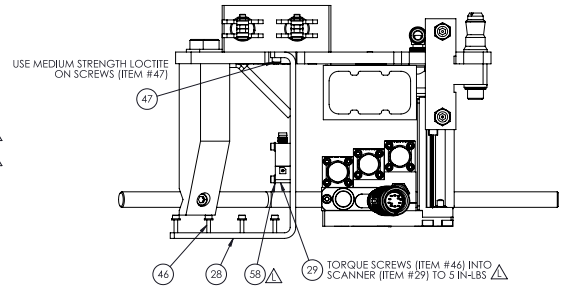

| | | | | | | | | | |
|------------|-------------------------------|--------------------------|-------------|---|--------|-------------|--------|--|-------------|
| USED ON: - | | MATERIAL: SEE PARTS LIST | | TOLERANCES - UNLESS NOTED: | | FINISH: - | | ASSEMBLY - FLIPABLE BOARDRUNNER TRIP-VALVE W/ TIP SEALER OPERATOR SIDE | |
| REV: | ADDED WASHERS AND TORQUE SPEC | 01SEP11 RED | 10SEP12 RED | BREAK ALL SHARP EDGES & CORNERS TO R0.05 (SEE DIMS) | INCHES | MILLIMETERS | DATE | 15JAN14 | 583XX586-02 |
| APPROVED: | S.M.T. | DATE: | 14-020 | DATE: | 14-020 | DATE: | 14-020 | REV: | 1=2 |
| APPROVED: | PDM | DATE: | 14-010 | DATE: | 14-020 | DATE: | 14-020 | REV: | 2 OF 2 |
| APPROVED: | PDM | DATE: | 14-005 | DATE: | 14-012 | DATE: | 14-012 | REV: | 2 OF 2 |

| ITEM | PART NUMBER | QTY. | DESCRIPTION |
|------|-------------|------|---------------------------|
| 1 | 579XX692 | 1 | CLAMP BLOCK |
| 2 | 789XX115 | 2 | BUSHING, .75 ID. |
| 3 | 789XX116 | 2 | BUSHING |
| 4 | 789XX117 | 2 | DRILL BUSHING |
| 5 | 579XX687 | 2 | WEDGE ROD |
| 6 | 579XX745 | 2 | CAM HANDLE |
| 7 | 091XX729 | 2 | CLEVIS PIN |
| 8 | 783XX362 | 2 | COMPRESSION SPRING |
| 9 | 579XX688 | 2 | BUSHING - WEDGE BAR |
| 10 | 884XX393 | 2 | SHOULDER BOLT; 6mm X 30mm |
| 11 | 579XX689 | 2 | WEDGE - SLIDE |
| 12 | 783XX361 | 2 | SPRING |

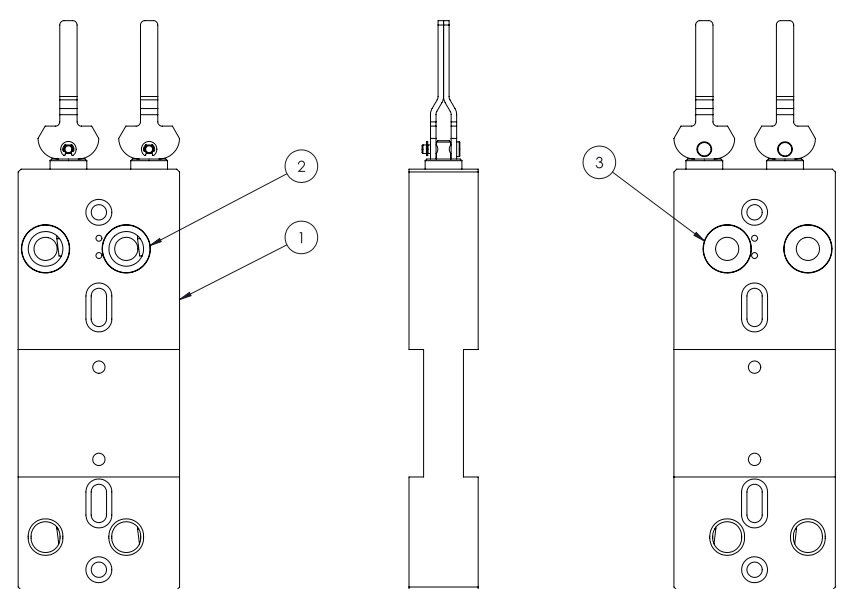
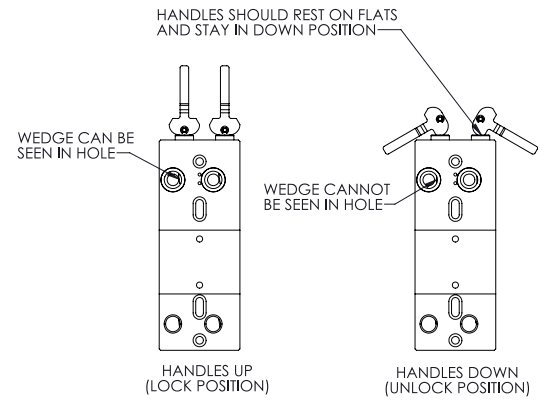
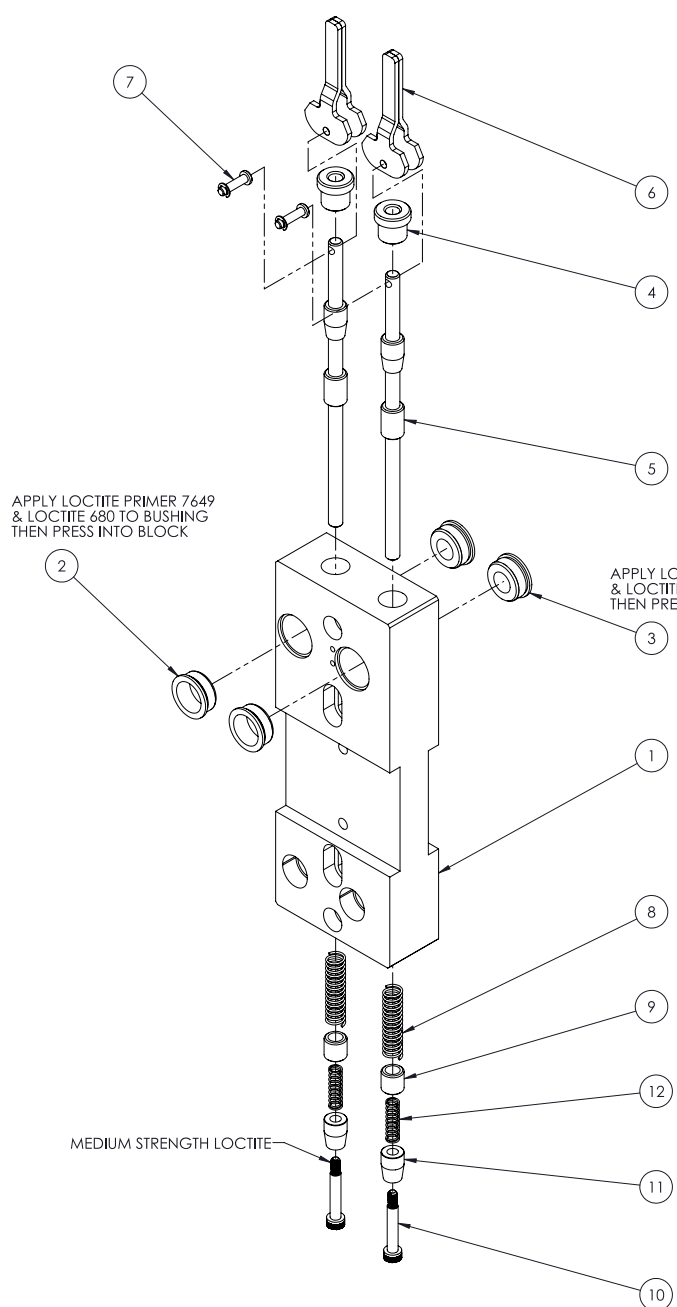

ASSEMBLY SHOULD MOVE SMOOTHLY
 ROTATE CAM HANDLE DOWN UNTIL IT REACHES THE FLAT.
 HANDLE SHOULD STAY IN THE DOWN POSITION, THE LOCKING WEDGE SHOULD BE RAISED ABOVE THE THRU HOLE.
 ROTATE THE CAM HANDLE BACK TO THE UP POSITION, THE LOCKING WEDGE SHOULD MOVE BACK DOWN INTO THE THRU HOLE.

| | | | | | |
|------------------|--|---|---------------------------|--|----------------|
| USED ON: - | THREAD LENGTH DIMENSIONS ARE FULL THREAD HOLES TO BE CHAMFERED ONE THREAD DEPTH MAX UNLESS OTHERWISE SPECIFIED | VALCO CINCINNATI | | PROPERTY CONTAINING PROPRIETARY INFORMATION. WORK MUST NOT BE REPRODUCED OR DISCLOSED WITHOUT WRITTEN PERMISSION AND MUST BE RETURNED UPON DEMAND. | |
| MTL: SEE P/L | FINISH: - | TOLERANCES - EXCEPT AS NOTED <small>FINISHED SURFACES</small> $\pm .005$ ANGULAR $\pm 1/2$ DEG. | | ASSEMBLY - MOUNTING BLOCK 3NCR DRIVE SIDE | |
| REV.: Δ : | BREAK ALL SHARP EDGES & CORNERS (DEBUR) UNLESS OTHERWISE SPECIFIED (10:15 MAX) | INCHES | MILLIMETERS | DATE | DRAWING NUMBER |
| Δ : | DRAWN BY S.M.T. | DECIMAL .X $\pm .030$ | DECIMAL [X.] ± 0.76 | 18DEC15 | 579XX747-01 |
| Δ : | CHECKED SMT | DECIMAL .XX $\pm .010$ | DECIMAL [X.X] ± 0.25 | SCALE | 1:2 |
| Δ : | APPROVED SMT | DECIMAL .XXX $\pm .005$ | DECIMAL [X.XX] ± 0.13 | SHEET | 1 OF 1 |
| Δ : | | | | SUPERSEDES | SMT7049 |
| | | | | SUPERSEDED BY | |

| ITEM | PART NUMBER | QTY. | DESCRIPTION |
|------|-------------|------|----------------------------------|
| 1 | 579XX747 | 1 | MOUNTING BLOCK; 3NCR; DRIVE SIDE |
| 10 | 579XX681 | 1 | PLATE - MOUNTING |
| 11 | 579XX744 | 6 | QUICK RELEASE POST |
| 12 | 782XX555 | 1 | AIR CYLINDER ASSY - DRIVE SIDE |
| 13 | 799XX582 | 2 | FITTING; 8mm TUBE X 1/8 NPT |
| 14 | 579XX682 | 1 | MOUNTING PLATE - VALVE |
| 15 | 583XX296 | 1 | VALVE CARTRIDGE |
| 16 | 782XX697 | 1 | AIR CYLINDER ASSY; DRIVE SIDE |
| 17 | 579XX699 | 1 | CASE - TIP SEALER PAD |
| 18 | 579XX698 | 1 | PAD |
| 20 | 799XX781 | 1 | BANJO FITTING; M5 X 8mm |
| 21 | 579XX683 | 1 | SPACER - COVER |
| 22 | 579XX684 | 1 | COVER, CYLINDER |
| 23 | 579XX677 | 1 | PLATE - MOUNTING |
| 24 | 579XX678 | 2 | GUIDE MOUNT |
| 25 | 579XX679 | 1 | GUIDE, TOP |
| 26 | 579XX680 | 1 | GUIDE, BOTTOM |
| 27 | 579XX686 | 1 | GUARD, PRODUCT |
| 28 | 579XX685 | 1 | BRACKET - SCANNER |
| 29 | 280XX290 | 1 | WENGLER SCANNER ASSY |
| 34 | 784XX097 | 6 | M8 WASHER |
| 35 | 784XX643 | 2 | WASHER SPLIT LOCK M8 SS |
| 36 | 784XX398 | 2 | SHCS M8 X 25 SS |
| 37 | 798XX097 | 4 | SHCS M5 X 10 S.S. |
| 38 | 884XX270 | 2 | SHCS M8 X 16 SS |
| 39 | 784XX373 | 2 | FHMS M5 X 1.6 BO |
| 41 | 798XX146 | 2 | SHCS M5 X 30 SS |
| 42 | 784XX423 | 2 | SHCS M4 X 10 SS |
| 43 | 784XX186 | 4 | SHCS M8 X 30 SS |
| 45 | 884XX236 | 4 | FHSS M8 X 1.6 SS |
| 46 | 798XX099 | 6 | SHCS M3 X 1.6 SS |
| 47 | 784XX051 | 2 | SHCS M4 X 12 SS |
| 49 | 798XX069 | 2 | SHCS M6 X 12 SS |
| 50 | - | - | - |
| 51 | 795XX614 | 1 | LABEL |
| 52 | 794XX917 | 1 | LABEL VALCO MELTON LOGO |
| 53 | 781XX430 | 1 | WARNING LABEL |
| 54 | 782XX549 | 1 | LABEL "3NCR" |
| 55 | 799XX817 | 1 | ELBOW 8mm POST X 8mm PUSH |

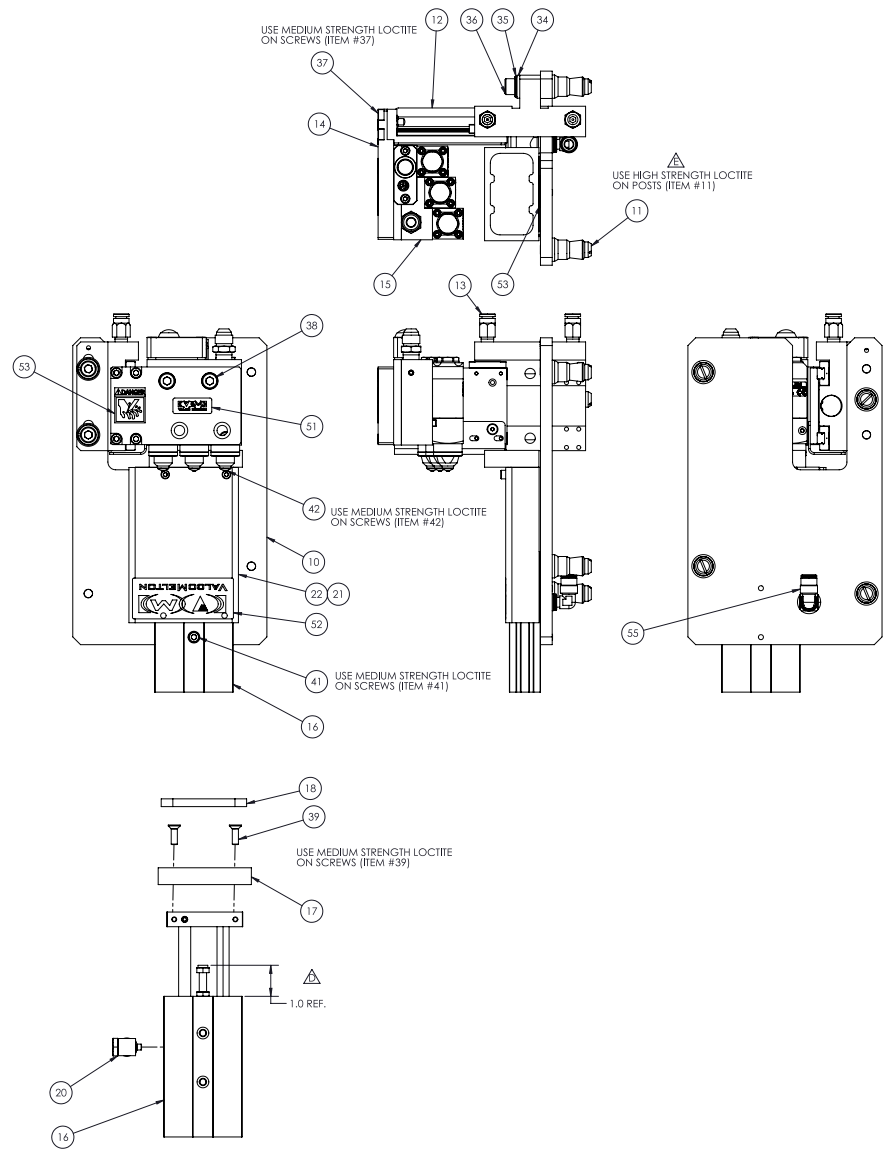
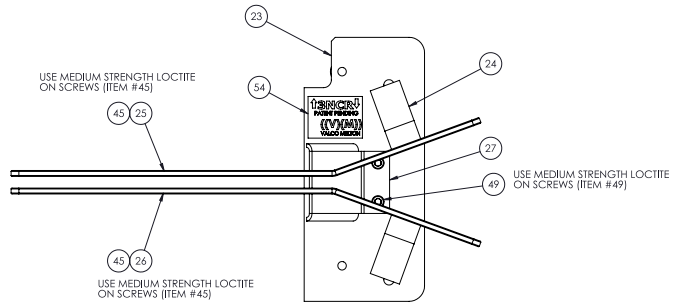
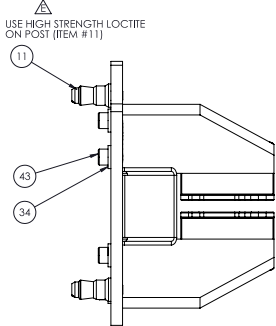
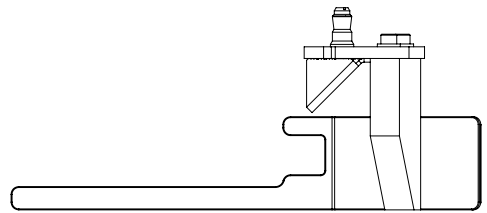
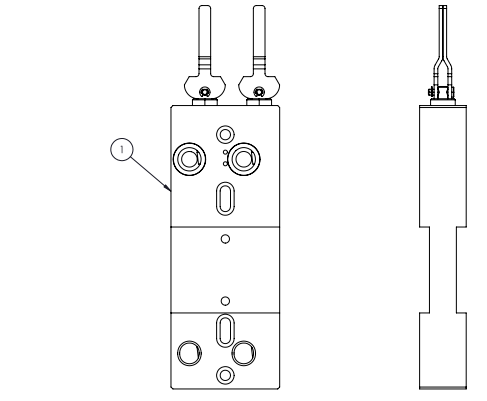

| REV | CONT. | DATE | BY | CHKD. | APP'D. | DESCRIPTION |
|-----|---------|---------|--------|-------|--------|----------------|
| 1 | REVISED | 15JAN14 | S.M.T. | | | INITIAL DESIGN |
| 2 | REVISED | 15JAN14 | S.M.T. | | | DESIGN CHANGES |
| 3 | REVISED | 15JAN14 | S.M.T. | | | DESIGN CHANGES |
| 4 | REVISED | 15JAN14 | S.M.T. | | | DESIGN CHANGES |
| 5 | REVISED | 15JAN14 | S.M.T. | | | DESIGN CHANGES |
| 6 | REVISED | 15JAN14 | S.M.T. | | | DESIGN CHANGES |
| 7 | REVISED | 15JAN14 | S.M.T. | | | DESIGN CHANGES |
| 8 | REVISED | 15JAN14 | S.M.T. | | | DESIGN CHANGES |
| 9 | REVISED | 15JAN14 | S.M.T. | | | DESIGN CHANGES |
| 10 | REVISED | 15JAN14 | S.M.T. | | | DESIGN CHANGES |
| 11 | REVISED | 15JAN14 | S.M.T. | | | DESIGN CHANGES |
| 12 | REVISED | 15JAN14 | S.M.T. | | | DESIGN CHANGES |
| 13 | REVISED | 15JAN14 | S.M.T. | | | DESIGN CHANGES |
| 14 | REVISED | 15JAN14 | S.M.T. | | | DESIGN CHANGES |
| 15 | REVISED | 15JAN14 | S.M.T. | | | DESIGN CHANGES |
| 16 | REVISED | 15JAN14 | S.M.T. | | | DESIGN CHANGES |
| 17 | REVISED | 15JAN14 | S.M.T. | | | DESIGN CHANGES |
| 18 | REVISED | 15JAN14 | S.M.T. | | | DESIGN CHANGES |
| 19 | REVISED | 15JAN14 | S.M.T. | | | DESIGN CHANGES |
| 20 | REVISED | 15JAN14 | S.M.T. | | | DESIGN CHANGES |
| 21 | REVISED | 15JAN14 | S.M.T. | | | DESIGN CHANGES |
| 22 | REVISED | 15JAN14 | S.M.T. | | | DESIGN CHANGES |
| 23 | REVISED | 15JAN14 | S.M.T. | | | DESIGN CHANGES |
| 24 | REVISED | 15JAN14 | S.M.T. | | | DESIGN CHANGES |
| 25 | REVISED | 15JAN14 | S.M.T. | | | DESIGN CHANGES |
| 26 | REVISED | 15JAN14 | S.M.T. | | | DESIGN CHANGES |
| 27 | REVISED | 15JAN14 | S.M.T. | | | DESIGN CHANGES |
| 28 | REVISED | 15JAN14 | S.M.T. | | | DESIGN CHANGES |
| 29 | REVISED | 15JAN14 | S.M.T. | | | DESIGN CHANGES |
| 30 | REVISED | 15JAN14 | S.M.T. | | | DESIGN CHANGES |
| 31 | REVISED | 15JAN14 | S.M.T. | | | DESIGN CHANGES |
| 32 | REVISED | 15JAN14 | S.M.T. | | | DESIGN CHANGES |
| 33 | REVISED | 15JAN14 | S.M.T. | | | DESIGN CHANGES |
| 34 | REVISED | 15JAN14 | S.M.T. | | | DESIGN CHANGES |
| 35 | REVISED | 15JAN14 | S.M.T. | | | DESIGN CHANGES |
| 36 | REVISED | 15JAN14 | S.M.T. | | | DESIGN CHANGES |
| 37 | REVISED | 15JAN14 | S.M.T. | | | DESIGN CHANGES |
| 38 | REVISED | 15JAN14 | S.M.T. | | | DESIGN CHANGES |
| 39 | REVISED | 15JAN14 | S.M.T. | | | DESIGN CHANGES |
| 40 | REVISED | 15JAN14 | S.M.T. | | | DESIGN CHANGES |
| 41 | REVISED | 15JAN14 | S.M.T. | | | DESIGN CHANGES |
| 42 | REVISED | 15JAN14 | S.M.T. | | | DESIGN CHANGES |
| 43 | REVISED | 15JAN14 | S.M.T. | | | DESIGN CHANGES |
| 44 | REVISED | 15JAN14 | S.M.T. | | | DESIGN CHANGES |
| 45 | REVISED | 15JAN14 | S.M.T. | | | DESIGN CHANGES |
| 46 | REVISED | 15JAN14 | S.M.T. | | | DESIGN CHANGES |
| 47 | REVISED | 15JAN14 | S.M.T. | | | DESIGN CHANGES |
| 48 | REVISED | 15JAN14 | S.M.T. | | | DESIGN CHANGES |
| 49 | REVISED | 15JAN14 | S.M.T. | | | DESIGN CHANGES |
| 50 | REVISED | 15JAN14 | S.M.T. | | | DESIGN CHANGES |
| 51 | REVISED | 15JAN14 | S.M.T. | | | DESIGN CHANGES |
| 52 | REVISED | 15JAN14 | S.M.T. | | | DESIGN CHANGES |
| 53 | REVISED | 15JAN14 | S.M.T. | | | DESIGN CHANGES |
| 54 | REVISED | 15JAN14 | S.M.T. | | | DESIGN CHANGES |
| 55 | REVISED | 15JAN14 | S.M.T. | | | DESIGN CHANGES |

| | | |
|--|---------|---|
| VALCO CRONNATI TOLERANCES - UNLESS NOTED: FRACTIONS DECIMALS .0005 .001 .002 .005 .010 .020 .050 .100 .150 .200 .300 .400 .500 .600 .700 .800 .900 1.000 1.500 2.000 3.000 4.000 5.000 6.000 8.000 10.000 15.000 20.000 30.000 40.000 50.000 60.000 80.000 100.000 | | ASSEMBLY - FLIPABLE BOARDRUNNER TRIP-VALVE W/ TIP SEALER DRIVE SIDE |
| DATE | 15JAN14 | REVISED |
| DATE | 1=2 | 583XX591-01 |
| DATE | 1 OF 2 | REVISED SMT6394 E |

| ITEM | PART NUMBER | QTY. | DESCRIPTION |
|------|-------------|------|----------------------------------|
| 1 | 579XX747 | 1 | MOUNTING BLOCK; 3NCR: DRIVE SIDE |
| 10 | 579XX681 | 1 | PLATE - MOUNTING |
| 11 | 579XX744 | 6 | QUICK-RELEASE POST |
| 12 | 782XX555 | 1 | AIR CYLINDER ASSY - DRIVE SIDE |
| 13 | 799XX582 | 2 | FITTING; 8mm TUBE X 1/8 NPT |
| 14 | 579XX682 | 1 | MOUNTING PLATE- VALVE |
| 15 | 583XX296 | 1 | VALVE CARTRIDGE |
| 16 | 782XX697 | 1 | AIR CYLINDER ASSY: DRIVE SIDE |
| 17 | 579XX699 | 1 | CASE - TIP SEALER PAD |
| 18 | 579XX698 | 1 | PAD |
| 20 | 799XX781 | 1 | BANJO FITTING; M5 X 8mm |
| 21 | 579XX683 | 1 | SPACER - COVER |
| 22 | 579XX684 | 1 | COVER, CYLINDER |
| 23 | 579XX677 | 1 | PLATE - MOUNTING |
| 24 | 579XX678 | 2 | GUIDE MOUNT |
| 25 | 579XX679 | 1 | GUIDE, TOP |
| 26 | 579XX680 | 1 | GUIDE PRODUCT BOTTOM |
| 27 | 579XX686 | 1 | GUARD, PRODUCT |
| 28 | 579XX685 | 1 | BRACKET - SCANNER |
| 29 | 280XX290 | 1 | WENGLER SCANNER ASSY |
| 34 | 784XX097 | 6 | M8 WASHER |
| 35 | 784XX663 | 2 | WASHER SPLIT LOCK M8 SS |
| 36 | 784XX398 | 2 | SHCS M8 X 25 SS |
| 37 | 798XX097 | 4 | SHCS M5 X 10 S.S. |
| 38 | 884XX270 | 2 | SHCS M8 X 16 SS |
| 39 | 784XX373 | 2 | FHMS M5 X 16 BO |
| 41 | 798XX146 | 2 | SHCS M5 X 30 SS |
| 42 | 784XX423 | 2 | SHCS M4 X 10 SS |
| 43 | 784XX186 | 4 | SHCS M8 X 30 SS |
| 45 | 884XX236 | 4 | FHSS M8 X 16 SS |
| 46 | 798XX099 | 6 | SHCS M3 X 16 SS |
| 47 | 784XX051 | 2 | SHCS M4 X 12 SS |
| 49 | 798XX069 | 2 | SHCS M6 X 12 SS |
| 50 | - | - | - |
| 51 | 795XX614 | 1 | LABEL |
| 52 | 794XX917 | 1 | LABEL, VALCO MELTON LOGO |
| 53 | 781XX430 | 1 | WARNING LABEL |
| 54 | 782XX549 | 1 | LABEL "3NCR" |
| 55 | 799XX817 | 1 | ELBOW 8mm POST X 8mm PUSH |

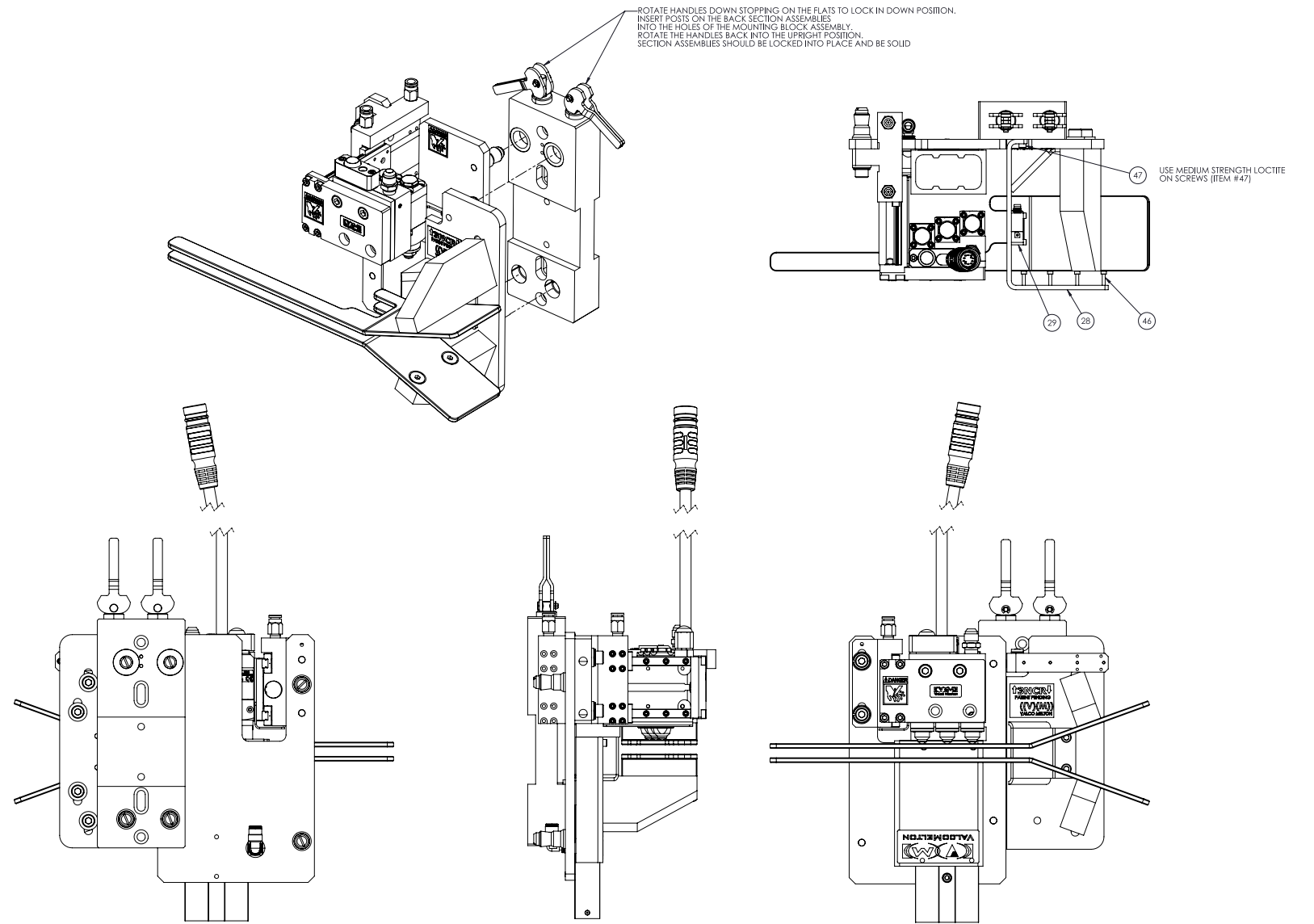

| | | | | |
|---------------------|--|--|---|-----------------|
| USED ON: - | THREAD LENGTH (DIMENSION) ARE TO DIMENSIONS UNLESS OTHERWISE SPECIFIED | VALCO CONNATI | PERFORM TO ASSEMBLY DRAWING REQUIREMENTS UNLESS OTHERWISE SPECIFIED | |
| MTL: SEE PARTS LIST | TOLERANCES - UNLESS NOTED: | ASSEMBLY - FLIPABLE BOARDRUNNER TRF-VALVE W/ TIP SEALER DRIVE SIDE | | |
| REV: - | BREAK ALL SHARP EDGES TO R0.25 UNLESS OTHERWISE SPECIFIED | INCHES | MILLIMETERS | DATE 15JAN14 |
| △ | DESIGNED BY S.M.T. | DATE 1=2 | DATE 1=2 | 583XX591-02 |
| △ | CHECKED PDM | DATE 2 OF 2 | DATE 2 OF 2 | REVISED SMT6394 |
| △ | APPROVED PDM | | | |

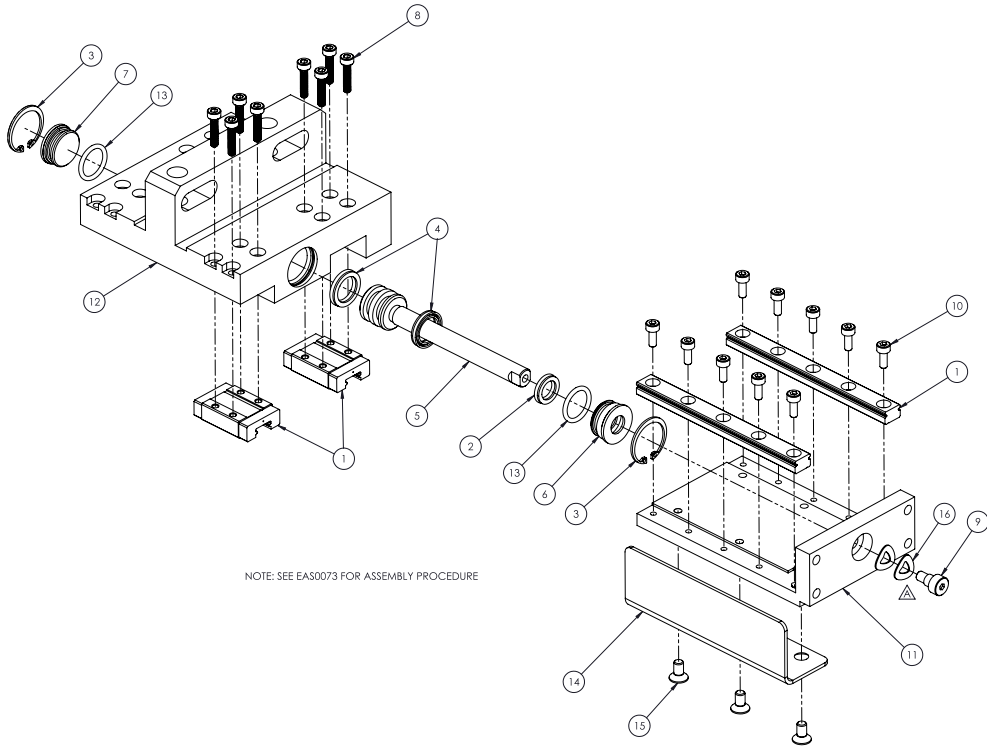

NOTE: SEE EAS0073 FOR ASSEMBLY PROCEDURE

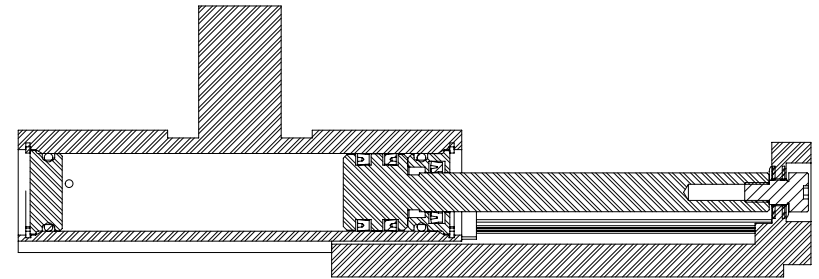
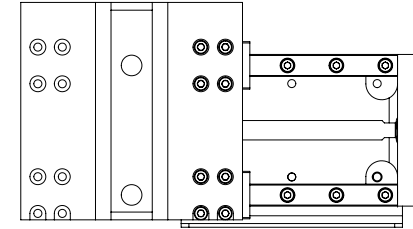
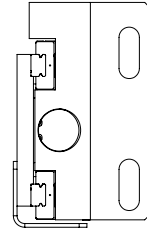

SECTION A-A
SCALE 2 : 1

| ITEM | PART NUMBER | DESCRIPTION | QTY. |
|------|-------------|----------------------------------|------|
| 1 | 790XX212 | BEARING RAIL ASSY | 2 |
| 2 | 746XX220 | ROD SEAL | 1 |
| 3 | 884XX281 | RETAINING RING | 2 |
| 4 | 746XX221 | U-CUP SEAL | 2 |
| 5 | 782XX552 | PISTON HEAD | 1 |
| 6 | 782XX360 | CYLINDER END: TOP | 1 |
| 7 | 782XX358 | CYLINDER END: BOTTOM | 1 |
| 8 | 784XX546 | SHCS M3 X 14 | 8 |
| 9 | 884XX400 | SHOULDER SCREW M4 X 5MM X 4MM LG | 1 |
| 10 | 784XX112 | SHCS M3 X 8 SS | 10 |
| 11 | 782XX551 | BASE - AIR CYLINDER | 1 |
| 12 | 782XX550 | CYLINDER BODY | 1 |
| 13 | 745XX124 | O-RING | 2 |
| 14 | 782XX553 | ROD GUARD | 1 |
| 15 | 798XX234 | FHSS M4 X 8 SS | 3 |
| 16 | 884XX399 | WAVE WASHER M5 | 2 |

USED ON: -
 MTL: SEE PARTS LIST

REV: -
 Δ - UPDATED BOM 9
 Δ - ADDED BOM 18
 Δ -
 Δ -
 Δ -
 Δ -

18.0015 A/C
 24.0015 A/C
 24.0015 A/C
 24.0015 A/C
 24.0015 A/C
 24.0015 A/C
 24.0015 A/C
 24.0015 A/C

BREAK ALL SHARP EDGES
 UNDER DIMENSION
 SPECIFIED

DATE: 21NOV13
 TIME: 1:11
 SHEET: 1 OF 1

TOLERANCES - UNLESS NOTED:
 INCHES: ±.0005
 MILLIMETERS: ±.025

VALCO
 CRANNATI

AIR CYLINDER ASSEMBLY
 W/ LINEAR BEARING
 DRIVE SIDE: 2.25 STROKE

782XX555-01

SM16356

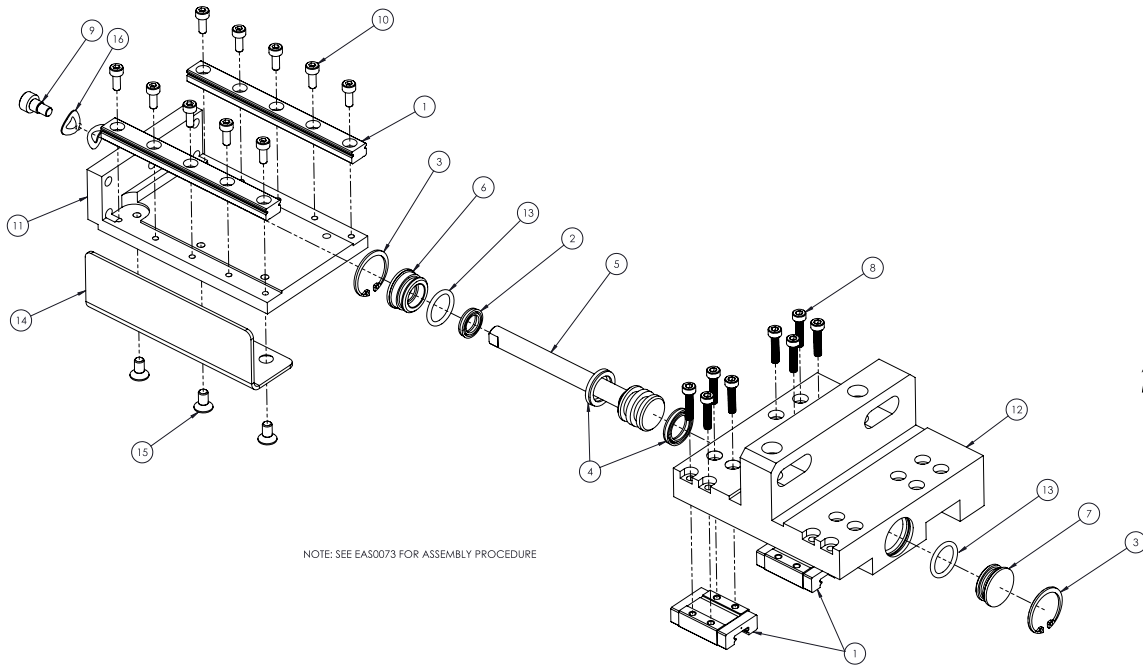

NOTE: SEE EAS0073 FOR ASSEMBLY PROCEDURE

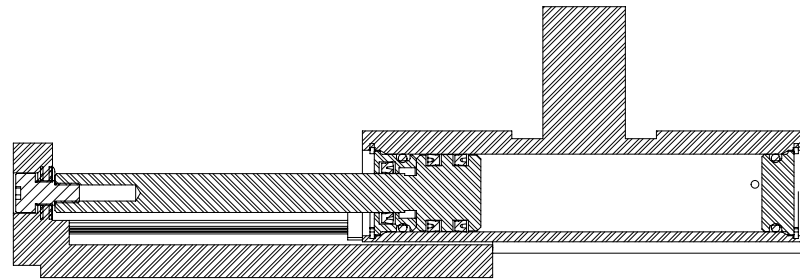
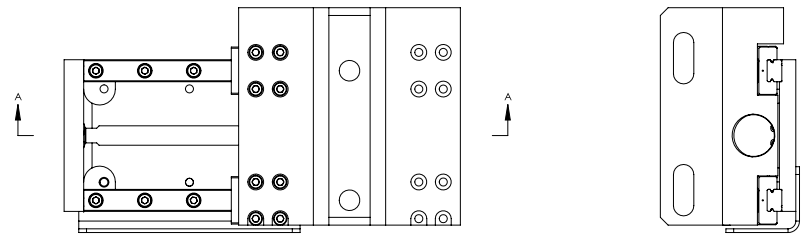

SECTION A-A
SCALE 2:1

| ITEM | PART NUMBER | DESCRIPTION | QTY. |
|------|-------------|----------------------------------|------|
| 1 | 790XX212 | BEARING ASSY 90mm LG | 2 |
| 2 | 746XX220 | ROD SEAL | 1 |
| 3 | 884XX281 | RETAINING RING | 2 |
| 4 | 746XX221 | U-CUP SEAL | 2 |
| 5 | 782XX552 | PISTON HEAD | 1 |
| 6 | 782XX360 | CYLINDER END; TOP | 1 |
| 7 | 782XX358 | CYLINDER END; BOTTOM | 1 |
| 8 | 784XX546 | SHCS M3 X 14 SS | 8 |
| 9 | 884XX400 | SHOULDER SCREW M4 X 5MM X 4MM LG | 1 |
| 10 | 784XX112 | SHCS M3 X 8 SS | 10 |
| 11 | 782XX551 | BASE - AIR CYLINDER | 1 |
| 12 | 782XX550 | CYLINDER BODY | 1 |
| 13 | 745XX124 | O-RING | 2 |
| 14 | 782XX553 | ROD GUARD | 1 |
| 15 | 798XX310 | FHMS M4 X 8 SS | 3 |
| 16 | 884XX399 | WAVE WASHER M5 | 2 |

| | | | | | | | |
|------------|---|--|-----------------|--|---|--|--|
| USED ON: - | | MATERIAL: SEE PARTS LIST | | | | | |
| FINISH: - | | THREADS: ENGLISH (UN/UNF) | | TOLERANCES: UNLESS OTHERWISE SPECIFIED | | | |
| REV: - | UNFINISHED SURF. TO BE FINISHED BY THE CUSTOMER | BREAK ALL SHARP EDGES TO R0.25 (0.010") UNLESS OTHERWISE SPECIFIED | UNIT: INCHES | UNIT: MILLIMETERS | AIR CYLINDER ASSEMBLY W/ LINEAR BEARING OPERATOR SIDE: 2.25 STROKE | | |
| △: - | UPDATED BOM 9 | 15.04.15 AYC | DATE: 21 NOV 13 | DATE: 21 NOV 13 | 782XX556-01 | | |
| △: - | ADDED BOM 16 | 20.01.15 AYC | DATE: 21 NOV 13 | DATE: 21 NOV 13 | 1 OF 1 | | |
| △: - | - | ISSUED: S.M.T. | DATE: 21 NOV 13 | DATE: 21 NOV 13 | 782XX556-01 | | |
| △: - | - | DESIGNED: PDM | DATE: 21 NOV 13 | DATE: 21 NOV 13 | 1 OF 1 | | |
| △: - | - | APPROVED: PDM | DATE: 21 NOV 13 | DATE: 21 NOV 13 | 1 OF 1 | | |

**Valve
Manifold
Assembly w/3,
524 EZT
Valves
(583xx296)**

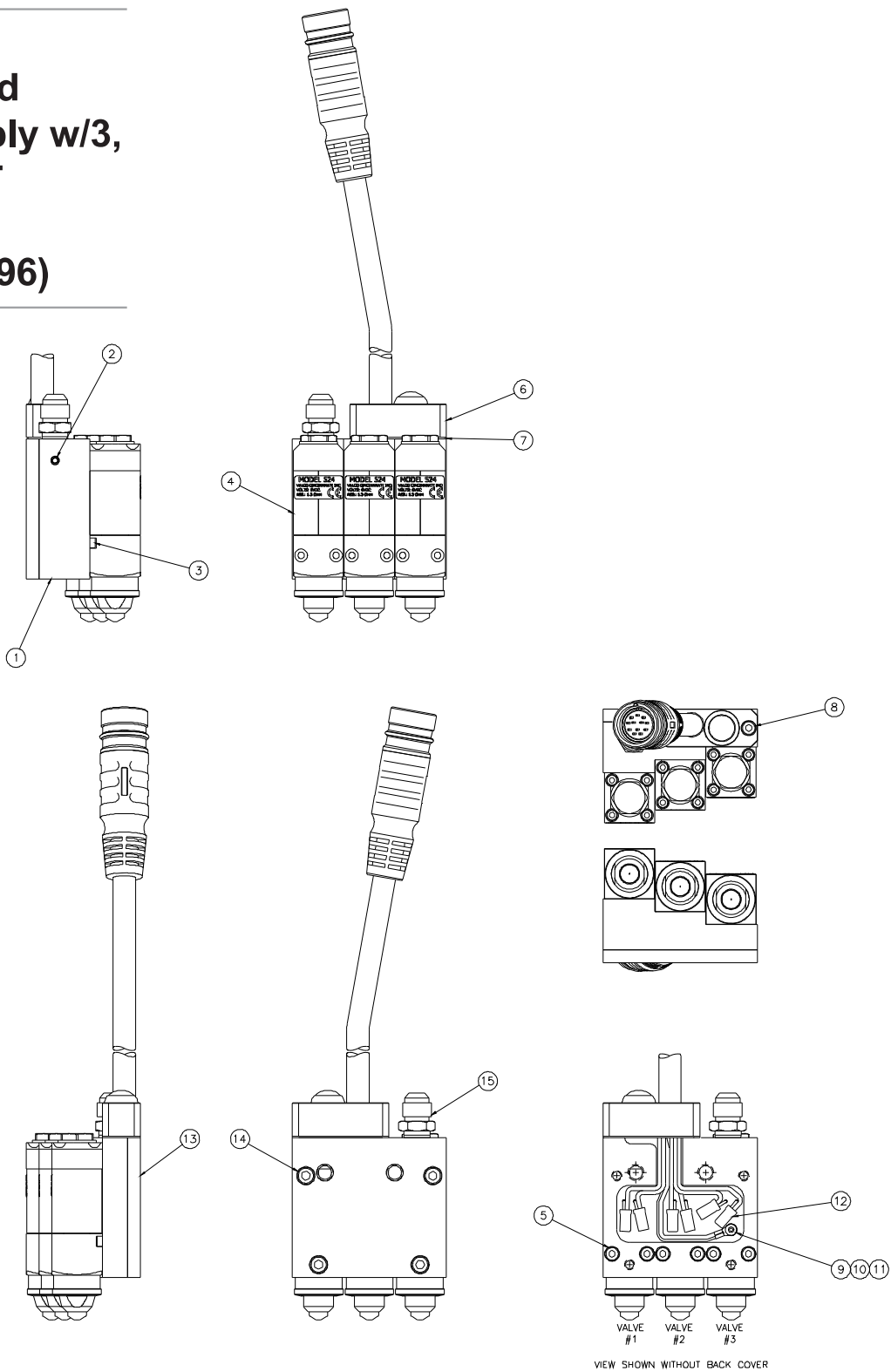

Valve Manifold Assembly
w/3, 524 EZT Valves (583xx296)
- Continued

| UNIT | DESCRIPTION | PART # | QTY |
|------|--------------------------------|----------|-----|
| 1 | MANIFOLD, GLUE, 3 534 VALVE | 583XX298 | 1 |
| 2 | SET SCREW M5 X 8 SS | 884XX235 | 1 |
| 3 | KEY STOCK SQUARE 5MM X 20MM LG | 763XX328 | 3 |
| 4 | ASSEMBLY 524EZT MANIFOLD MOUNT | 707XX625 | 3 |
| 5 | SHCS M4 X 14 SS. | 884XX100 | 6 |
| 6 | ASSEMBLY PURGE CONNECTOR BLOCK | 583XX300 | 1 |
| 7 | GASKET, PURGE BLOCK | 583XX301 | 1 |
| 8 | SHCS M4 X 20MM LG S.S. | 784XX910 | 2 |
| 9 | LOCK WASHER M3 | 784XX315 | 1 |
| 10 | WIRE TERMINAL; RING 213909 | 075XX060 | 1 |
| 11 | BHCS M3 X 6 SS | 784XX541 | 1 |
| 12 | SPARE WIRE CAP; 16-14AWG | 075XX311 | 8 |
| 13 | PLATE BACK | 583XX297 | 1 |
| 14 | SHCS M5 X 12 SS | 784XX125 | 4 |
| 15 | CONNECTOR 3/8 JIC X 1/4 NPT SS | 792XX081 | 1 |

| ITEM | PART NO. | QTY | DESCRIPTION |
|------|----------|-----|------------------------------|
| 1 | 583XX298 | 1 | MANIFOLD; THREE VALVE |
| 2 | 884XX235 | 1 | SET SCREW; M5 X 8mm LG. S.S. |
| 3 | 763XX328 | 3 | KEY SQUARE 5mm X 20mm LG. |
| 4 | 707XX625 | 3 | S24 VALVE; MANIFOLD MOUNT |
| 5 | 884XX100 | 6 | SHCS; M4 X 14mm LG. S.S. |
| 6 | 583XX300 | 1 | SWITCH ASSEMBLY |
| 7 | 583XX301 | 1 | GASKET |
| 8 | 784XX910 | 2 | SHCS; M4 X 20mm LG. S.S. |
| 9 | 784XX315 | 1 | LOCK WASHER; M3 |
| 10 | 075XX060 | 1 | RING TERMINAL |
| 11 | 784XX541 | 1 | BHCS; M3 X 6mm LG. S.S. |
| 12 | 075XX311 | 8 | WIRE CAP |
| 13 | 583XX297 | 1 | BACK PLATE |
| 14 | 784XX125 | 4 | SHCS; M5 X 12mm LG. S.S. |
| 15 | 792XX081 | 1 | FITTING; 1/4 NPT X 3/8 JIC |

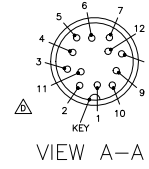
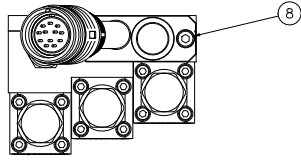

WIRING DIAGRAM

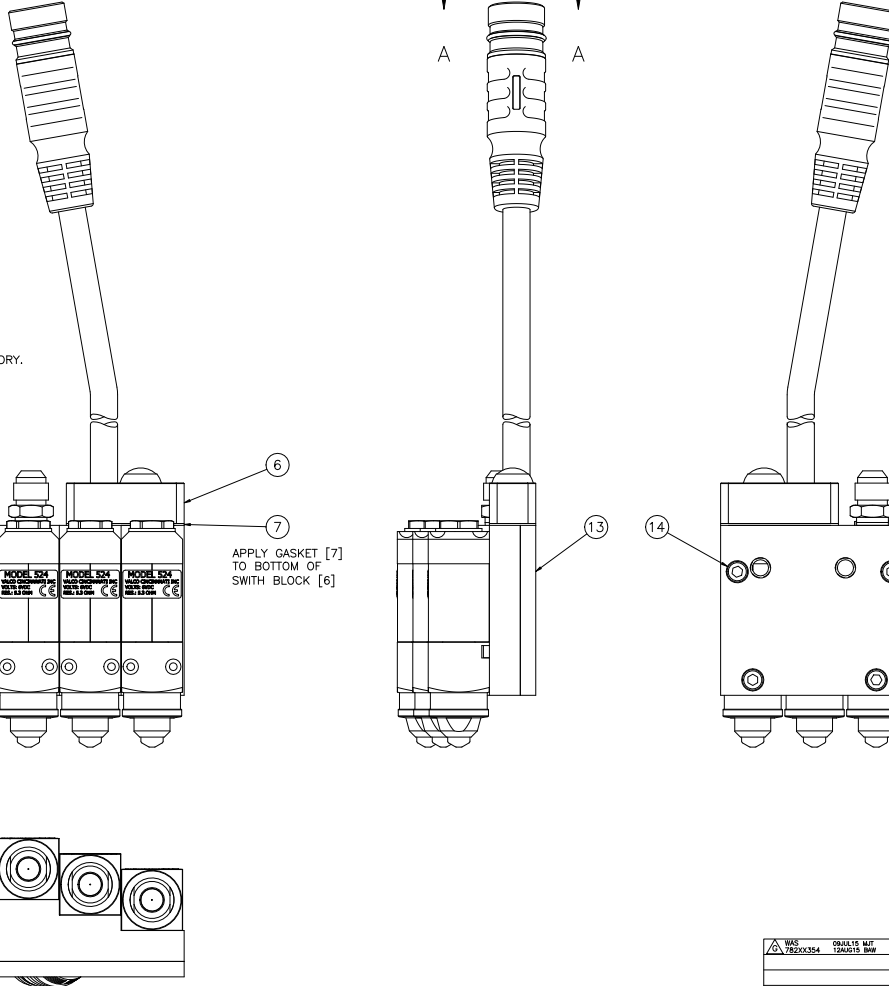
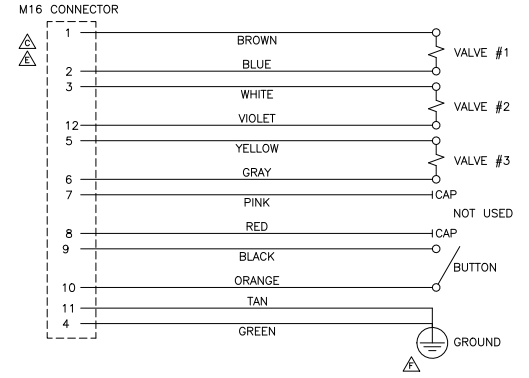

APPLY LOCTITE 7649 ACTIVATOR TO SCREW [2] AND ALLOW TO DRY.
 APPLY LOCTITE 271 TO SCREW AND THREAD INTO HOLE UNTIL
 END OF SCREW IS FLUSH WITH THE MANIFOLD.
 SCREW MUST HAVE A WATERTIGHT SEAL.

APPLY GASKET [7]
 TO BOTTOM OF
 SWITCH BLOCK [6]

SEAL THREAD WITH
 TEFLON TAPE

VIEW SHOWN WITHOUT BACK COVER

NOTE:
 TEST ASSEMBLY USING ETS366

| | | | | | | |
|-----------------|---------------------------|---|--|--|--|---|
| MAS 782XX354 | GRASIS MPT 12A0115 BHW | USED ON: -- MTL: SEE P/L | THIRD DIMENSION ARE ALL THIRD DIMENSIONS TO BE DIMENSIONED ONE THIRD DEPTH AND UNLESS OTHERWISE SPECIFIED | VALCO CORPORATION | PROPERTY OWNERSHIP PRESERVED/PROTECTED WHICH MAY BE REPRODUCED OR TRANSMITTED IN ANY FORM OR BY ANY MEANS, ELECTRONIC OR MECHANICAL, INCLUDING PHOTOCOPYING, RECORDING, OR BY ANY INFORMATION SYSTEM, WITHOUT PERMISSION IN WRITING FROM VALCO CORPORATION | |
| FINISH: -- | | REV: A B C D E F G H I J K L M N O P Q R S T U V W X Y Z AA AB AC AD AE AF AG AH AI AJ AK AL AM AN AO AP AQ AR AS AT AU AV AW AX AY AZ BA BB BC BD BE BF BG BH BI BJ BK BL BM BN BO BP BQ BR BS BT BU BV BW BX BY BZ CA CB CC CD CE CF CG CH CI CJ CK CL CM CN CO CP CQ CR CS CT CU CV CW CX CY CZ DA DB DC DD DE DF DG DH DI DJ DK DL DM DN DO DP DQ DR DS DT DU DV DW DX DY DZ EA EB EC ED EE EF EG EH EI EJ EK EL EM EN EO EP EQ ER ES ET EU EV EW EX EY EZ FA FB FC FD FE FF FG FH FI FJ FK FL FM FN FO FP FQ FR FS FT FU FV FW FX FY FZ GA GB GC GD GE GF GG GH GI GJ GK GL GM GN GO GP GQ GR GS GT GU GV GW GX GY GZ HA HB HC HD HE HF HG HH HI HJ HK HL HM HN HO HP HQ HR HS HT HU HV HW HX HY HZ IA IB IC ID IE IF IG IH II IJ IK IL IM IN IO IP IQ IR IS IT IU IV IW IX IY IZ JA JB JC JD JE JF JG JH JI JJ JK JL JM JN JO JP JQ JR JS JT JU JV JW JX JY JZ KA KB KC KD KE KF KG KH KI KJ KK KL KM KN KO KP KQ KR KS KT KU KV KW KX KY KZ LA LB LC LD LE LF LG LH LI LJ LK LL LM LN LO LP LQ LR LS LT LU LV LW LX LY LZ MA MB MC MD ME MF MG MH MI MJ MK ML MN MO MP MQ MR MS MT MU MV MW MX MY MZ NA NB NC ND NE NF NG NH NI NJ NK NL NM NO NP NQ NR NS NT NU NV NW NX NY NZ OA OB OC OD OE OF OG OH OI OJ OK OL OM ON OO OP OQ OR OS OT OU OV OW OX OY OZ PA PB PC PD PE PF PG PH PI PJ PK PL PM PN PO PP PQ PR PS PT PU PV PW PX PY PZ QA QB QC QD QE QF QG QH QI QJ QK QL QM QN QO QP QQ QR QS QT QU QV QW QX QY QZ RA RB RC RD RE RF RG RH RI RJ RK RL RM RN RO RP RQ RR RS RT RU RV RW RX RY RZ SA SB SC SD SE SF SG SH SI SJ SK SL SM SN SO SP SQ SR SS ST SU SV SW SX SY SZ TA TB TC TD TE TF TG TH TI TJ TK TL TM TN TO TP TQ TR TS TT TU TV TW TX TY TZ UA UB UC UD UE UF UG UH UI UJ UK UL UM UN UO UP UQ UR US UT UU UV UW UX UY UZ VA VB VC VD VE VF VG VH VI VJ VK VL VM VN VO VP VQ VR VS VT VU VV VW VX VY VZ WA WB WC WD WE WF WG WH WI WJ WK WL WM WN WO WP WQ WR WS WT WU WV WW WX WY WZ XA XB XC XD XE XF XG XH XI XJ XK XL XM XN XO XP XQ XR XS XT XU XV XW XX XY XZ YA YB YC YD YE YF YG YH YI YJ YK YL YM YN YO YP YQ YR YS YT YU YV YW YX YY YZ ZA ZB ZC ZD ZE ZF ZG ZH ZI ZJ ZK ZL ZM ZN ZO ZP ZQ ZR ZS ZT ZU ZV ZW ZX ZY ZZ | TOLERANCES - UNLESS NOTED MILLIMETERS ±.125/ INCHES MILLIMETERS HOLE ALL SHARP EDGES & CHAMFER EDGES UNLESS OTHERWISE SPECIFIED (SEE 390) FINISH: 2 ±.030 3 ±.010 4 ±.006 5, 200 6, 250 7, 150 8, 250 9, 250 10, 250 11, 250 12, 250 13, 250 14, 250 15, 250 16, 250 17, 250 18, 250 19, 250 20, 250 21, 250 22, 250 23, 250 24, 250 25, 250 26, 250 27, 250 28, 250 29, 250 30, 250 31, 250 32, 250 33, 250 34, 250 35, 250 36, 250 37, 250 38, 250 39, 250 40, 250 41, 250 42, 250 43, 250 44, 250 45, 250 46, 250 47, 250 48, 250 49, 250 50, 250 51, 250 52, 250 53, 250 54, 250 55, 250 56, 250 57, 250 58, 250 59, 250 60, 250 61, 250 62, 250 63, 250 64, 250 65, 250 66, 250 67, 250 68, 250 69, 250 70, 250 71, 250 72, 250 73, 250 74, 250 75, 250 76, 250 77, 250 78, 250 79, 250 80, 250 81, 250 82, 250 83, 250 84, 250 85, 250 86, 250 87, 250 88, 250 89, 250 90, 250 91, 250 92, 250 93, 250 94, 250 95, 250 96, 250 97, 250 98, 250 99, 250 100, 250 | ASSEMBLY - VALVE MANIFOLD THREE S24 VALVES BOARDRUNNER | DATE 3DECO9 SCALE 1=1 SHEET 1 OF 1 SUPERSEDES SMT4578B | DRAWING NUMBER 583XX296-01 SUPPLEMENTED BY |



TRI-VALVE, NON-CONTACT BOARDRUNNER™ GLUE STATION

Components Tri-Valve Non-Contact BoardRunner® - 524 Glue Valve - 707xx625

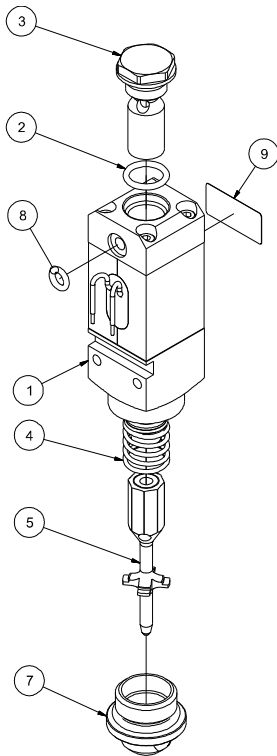

| ITEM | PN | DESCRIPTION |
|--------------------------------------|----------|-------------------------|
| 1 | 707XX626 | ASSEMBLY COIL 524 VALVE |
| 2 | 745XX340 | O-RING |
| 3 | 707XX609 | PLUG, STOP |
| 4 | 783XX042 | SPRING |
| 5 | 707XX529 | PLUNGER ASSEMBLY |
| 6 | 707XX524 | NOZZLE SEAT |
| 7 | 707XX518 | NOZZLE BODY |
| 8 | 745XX026 | O-RING |
| 9 | 782XX211 | LABEL, CE LOGO |
| Nozzle seat options, low restriction | | |
| | 707xx521 | Nozzle seat, 0.25 mm |
| | 707xx522 | Nozzle seat, 0.30 mm |
| | 707xx523 | Nozzle seat, 0.35 mm |
| | 707xx524 | Nozzle seat, 0.40 mm |
| | 707xx525 | Nozzle seat, 0.50 mm |
| | 707xx526 | Nozzle seat, 0.60 mm |
| | 707xx527 | Nozzle seat, 0.70 mm |
| | 707xx528 | Nozzle seat, 0.80 mm |