

The **08 HP valve** is a pneumatically operated, high-performance glue valve for contact or non-contact extrusion application. The design of the valve ensures a very high cycle rate and cycle life. The 08 HP valve provides millions of cycles before servicing is necessary.

Another advantage of the 08 HP valve is its capacity to handle high fluid pressure and a range of fluid viscosity, from 500 to 20,000 cps. An assortment of application nozzles and adapters allows the 08 HP valve to be used in a wide variety of applications.

Applications

Folding carton, corrugated lap gluing, cartoning, “sift-proof” and insect-proof gluing, window gluing, ribbon patterns, coating, and many other high-speed applications without limitation in viscosity

Technical Data

Height	4.8 in. (122 mm)
Width	1.4 in. (35.5 mm)
Operating solenoid valve	3-way valve
Control air pressure	90 psi (6 bar)
Max. cycle rate	8000/min
Max. fluid pressure	580 psi (40 bar)
Max. viscosity	20,000 cps
Nozzle types used	408, 409, 438, 436, 81, 0825

08 HP ASSEMBLIES				
Imperial (USA)	Air fitting	Glue fitting	Nozzle adapter	For use with nozzle(s)
704xx119	1/4-in. O.D. polytube	9/16-18 JIC, male	438 adapter, 3/8-24, male (703xx902)	438 and 436
704xx120	1/4-in. O.D. polytube	9/16-18 JIC, male	M16 adapter with retainer nut (704xx112)	408 and 409
704xx532	1/4-in. O.D. polytube	9/16-18 JIC, male	Same as above, with O-ring groove (704xx537)	408 ceramic
704xx121	1/4-in. O.D. polytube	9/16-18 JIC, male	90° adapter with retainer nut (704xx111)	408 and 409
704xx533	1/4-in. O.D. polytube	9/16-18 JIC, male	Same as above, with O-ring groove (704xx529)	408 ceramic
704xx122	1/4-in. O.D. polytube	9/16-18 JIC, male	No nozzle adapter	81 and 0825
704xx158	1/4-in. O.D. polytube	9/16-18 JIC, male	Same as above, with 1/8-NPT glue fitting	81 and 0825
Metric	Air fitting	Glue fitting	Nozzle adapter	For use with nozzle(s)
704xx123	6-mm O.D. tube	1/4 BSPP, male	438 adapter, 3/8-24, male (703xx902)	438 and 436
704xx124	6-mm O.D. tube	1/4 BSPP, male	M16 adapter with retainer nut (704xx112)	408 and 409
704xx530	6-mm O.D. tube	1/4 BSPP, male	Same as above, with O-ring groove (798xx356)	408 ceramic
704xx125	6-mm O.D. tube	1/4 BSPP, male	90° adapter with retainer nut (704xx111)	408 and 409
704xx535	6-mm O.D. tube	1/4 BSPP, male	Same as above, with O-ring groove (704xx529)	408 ceramic
704xx126	6-mm O.D. tube	1/4 BSPP, male	No nozzle adapter	81 and 0825



08 HP High-Performance Glue Valve

for contact or non-contact extrusion application without viscosity limitation

DS004

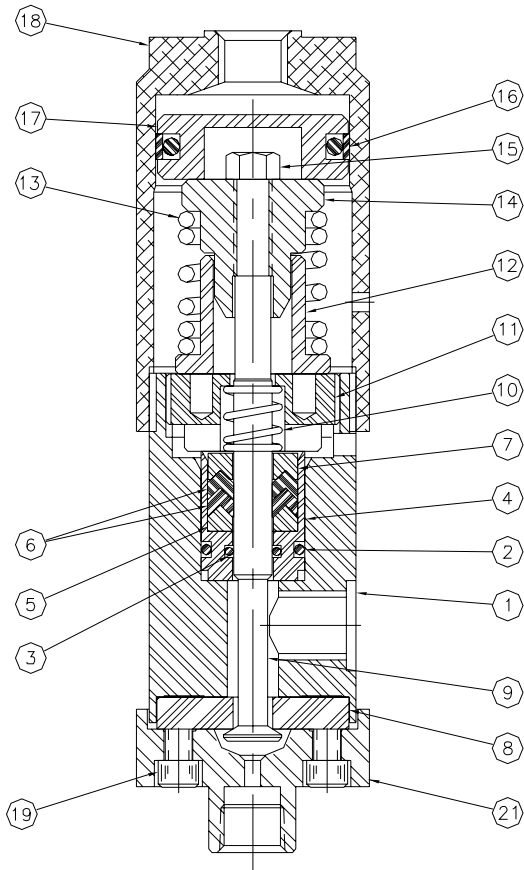

Order number (see front page for assemblies)
 08 HP valve 703xx907

Replacement parts

1	Manifold Body	703XX897
2	O-Ring	745XX518
3	O-Ring	745XX516
4	Cartridge, 0800.8600	703XX898
5	Clamping Ring	793XX403
6	Seal	745XX953
7	Metal Header, Fem.	793XX401
8	Sealing Washer	745XX951
9	Piston Rod	703XX896
10	Spring	793XX427
11	Tension Nut	793XX411
12	Spring Sleeve	784XX290
13	Spring, Comp.....	793XX428
14	Stroke Adjustment Nut	784XX289
15	Nut, Lock, M6.....	798XX416
16	Seal, Piston.....	745XX952
17	Piston, 0832.....	703XX864
18	Pneumatic Housing.....	703XX895
19	Screw.....	784XX067
20	Label.....	795XX614
21	Washer, Copper.....	793XX470

Nozzle adapters

A	Adapter for 438 nozzle	703xx902
B	Adapter for retainer nozzle	704xx112
C	Right-angle adapter assembly	704xx111

For more information on mounting brackets, block nozzles, pattern blades, and multi-nozzle adapters, contact the Valco Cincinnati office.

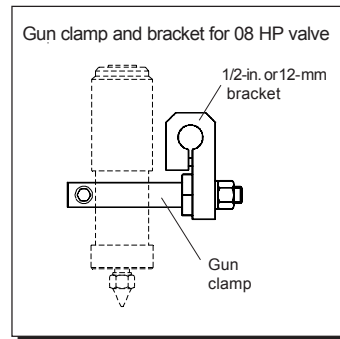
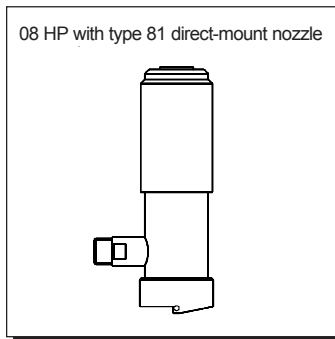
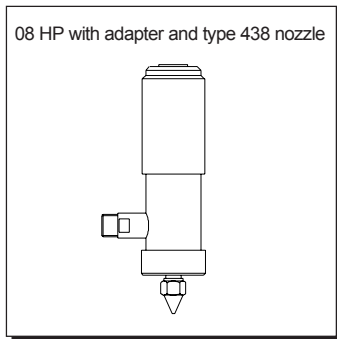
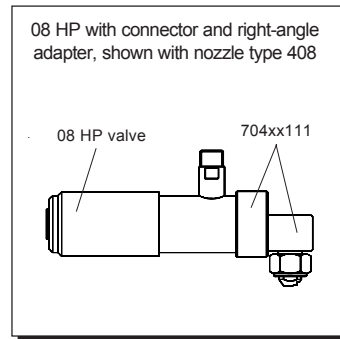
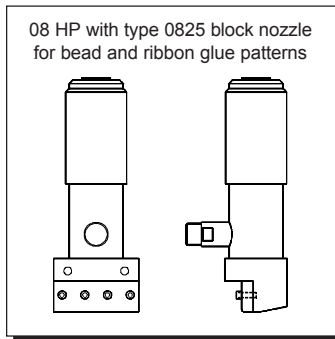
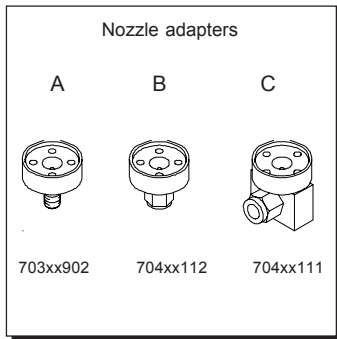

Design specifications subject to change without notice.

DS004

May 2006

Valco Cincinnati, Inc.
 411 Circle Freeway Drive
 Cincinnati, OH 45246
 TEL: (513) 874-6550
 FAX: (513) 874-3612
 Email: sales@valcocincinnati.com
 Web: http://www.valcocincinnati.com

Valco Cincinnati Limited
 Hortonwood 32
 Telford, TFI 7YN, England
 TEL: (+44) 1952-677911
 FAX: (+44) 1952-677945
 Email: sales@valco.co.uk
 Web: http://www.valco.co.uk

Valco Cincinnati GmbH
 Storkower Strasse 6
 D-15749 Gallun, Germany
 TEL: (+49) 337 648 700
 FAX: (+49) 337 648 7070
 Email: info@valcogmbh.de



Model 08HP Glue Valve, Components/Replacement Parts

Model 08HP Valve Components			
	ITEM	PN	DESCRIPTION
		703xx907	Field replacement module. Includes all items listed below.
	1	703xx897	Manifold body
	2	745xx518	O-ring
	3	745xx516	O-ring
	4	703xx898	Cartridge
	5	793xx403	Clamping ring
	6	745xx953	Seal
	7	793xx401	Metal header
	8	745xx951	Sealing washer
	9	703xx896	Piston rod
	10	793xx427	Spring
	11	793xx411	Tension nut
	12	784xx290	Spring sleeve
	13	793xx428	Spring
	14	784xx289	Stroke adjustment nut
	15	798xx416	Locknut
	16	745xx952	Piston seal
	17	703xx864	Piston
	18	703xx895	Housing
19	784xx067	Socket head cap screw	
		793xx470	Glue fitting sealing washer (not shown)

Model 08HP Seal Kit and Rebuild Kit	
PN	DESCRIPTION
703xx994	Rebuild kit. Includes seal kit above plus items 9,10, 13, and items below: 703xx990 Piston rod assembly 794xx923 Feeler gauge 794xx889 Hex key 794xx892 Tube brush 794xx891 Spanner wrench 794xx893 Seal install tool 794xx044 Carrying case
703xx992	Seal kit, 08HP. Includes items 2,3,6,8, and 16
707xx296	Seal kit, 08HP EP. same as above except items 2 and 3, replaced by EP seals 746XX217 O-ring EP 746XX218 O-ring EP



**CORE WINDING
VALVE & APPLICATOR OPTIONS PRE-2011**

08HP Series Valve & Applicator

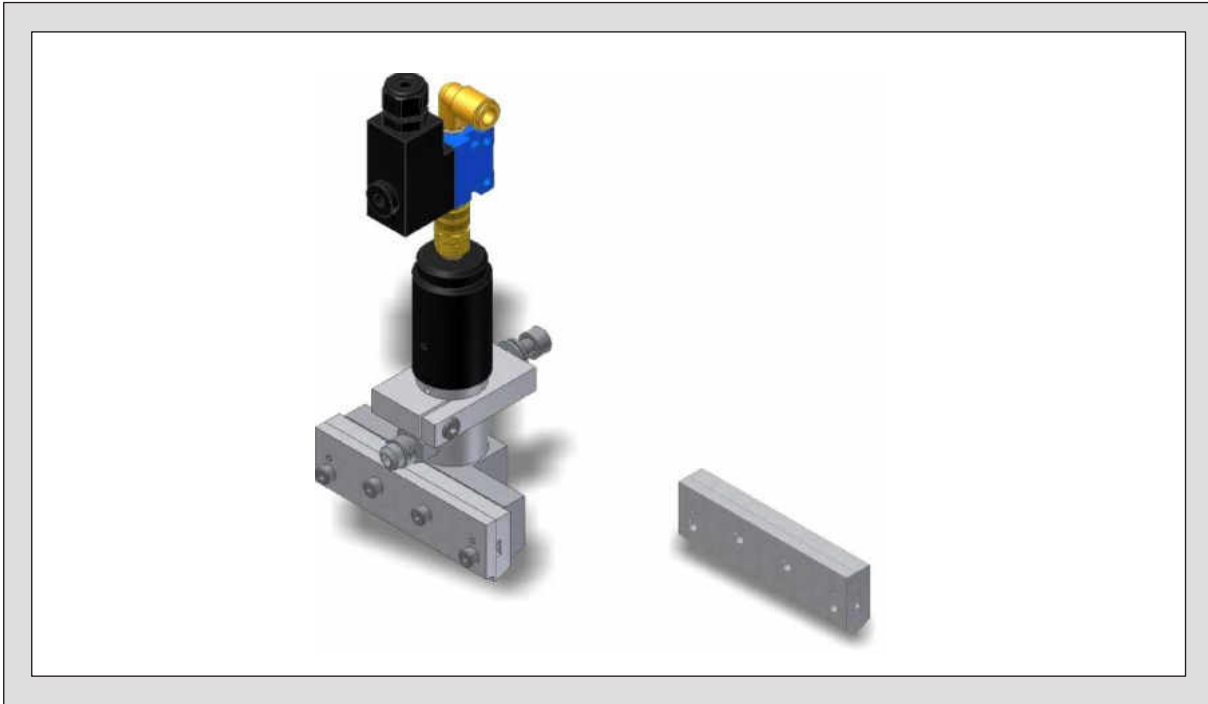

High pressure application 08HP valve, for pressures in excess of 100 psi

Core Winder Valve and Applicator Head, 08HP valve, 4-inch	
PN	DESCRIPTION
708xx782	O8HP valve w/ head 4 in. wide paper max.
708xx780	4-inch replacement head, hardened 440C stainless
4-in. blank pattern shims. Shims to be cut at application. Stainless steel	
708xx549	Pattern shim - .004 thk.
708xx548	Pattern shim - .006 thk.
708xx739	Pattern shim - .008 thk.
708xx611	Pattern shim - .010 thk.



CORE WINDING VALVE & APPLICATOR OPTIONS PRE-2011

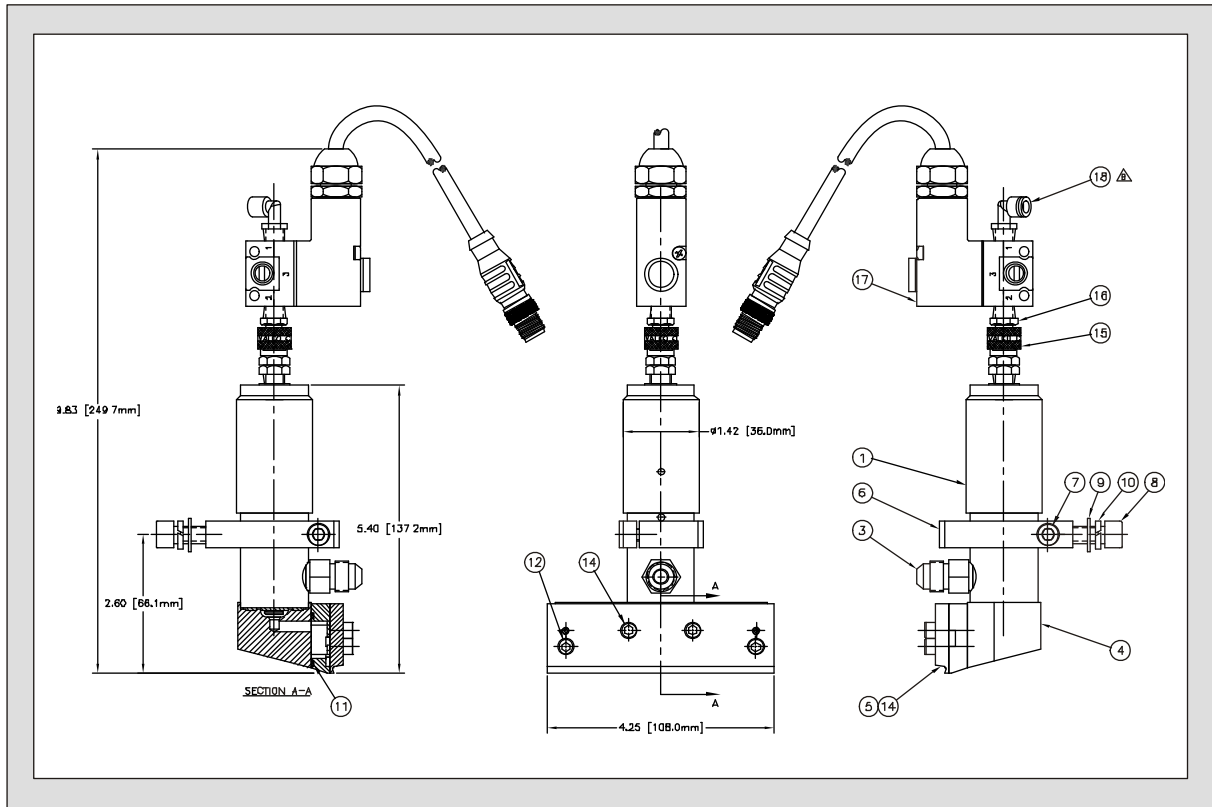

High Pressure Valve Components - 4-inch

ITEM	PN	DESCRIPTION
1	703xx907	08HP valve assembly
3	792xx136	1/8 BSPP x 9-16-18 JIC
4	709xx519	Manifold, block nozzle
5	708xx780	Assembly, blade set
6	794xx877	Clamp
7	798xx152	SHCS, M6 x 12 SS
8	784xx442	SHCS M8 x 20 SS
9	784xx097	Flat washer, M8
10	798xx360	Lockwasher, 8mm, SS
11	745xx104	O-ring
12	784xx409	SHCS M5 x 25 SS
14	798xx194	SHCS M5 x 14 SS
15	750xx001	Swivel fitting, female
16	750xx009	Male swivel
17	411xx118	3-way valve assembly, 24V
18	799xx542	1/8 NPT x 5/16 tube